

AS BUILT DRAWING OF HOUSING LAYOUT

AT NARASAPURA INDUSTRIAL AREA KOLAR TALUK & DIST.



Available Vacant sites for E-Auction		
Description	Dimension	Total no. of Vacant sites
EWS	6.0MX9.0M	54
LIG	9.0MX12.0M	59
MIG	12.0MX18.0M	10
HIG	15.0MX24.0M	03
ODD SITES		15
Grand Total		141

Devalapalli Ar
Assistant Engineer
 Karnataka Industrial Area Development Board
 No.14/3, 2nd Floor, CFC Building,
 Maharshi Aravinda Bhavan, Nrupatunga Road,
 Bangalore (Karnataka) - 560 001

Shankar
Assistant Executive Engineer
 Karnataka Industrial Area Development Board
 No.14/3, 2nd Floor, CFC Building,
 Maharshi Aravinda Bhavan, Nrupatunga Road,
 Bangalore (Karnataka) - 560 001

Jilavally
Executive Engineer-2
 Karnataka Industrial Area Development Board
 No.14/3, 2nd Floor, CFC Building,
 Maharshi Aravinda Bhavan, Nrupatunga Road,
 Bangalore (Karnataka) - 560 001

9*12

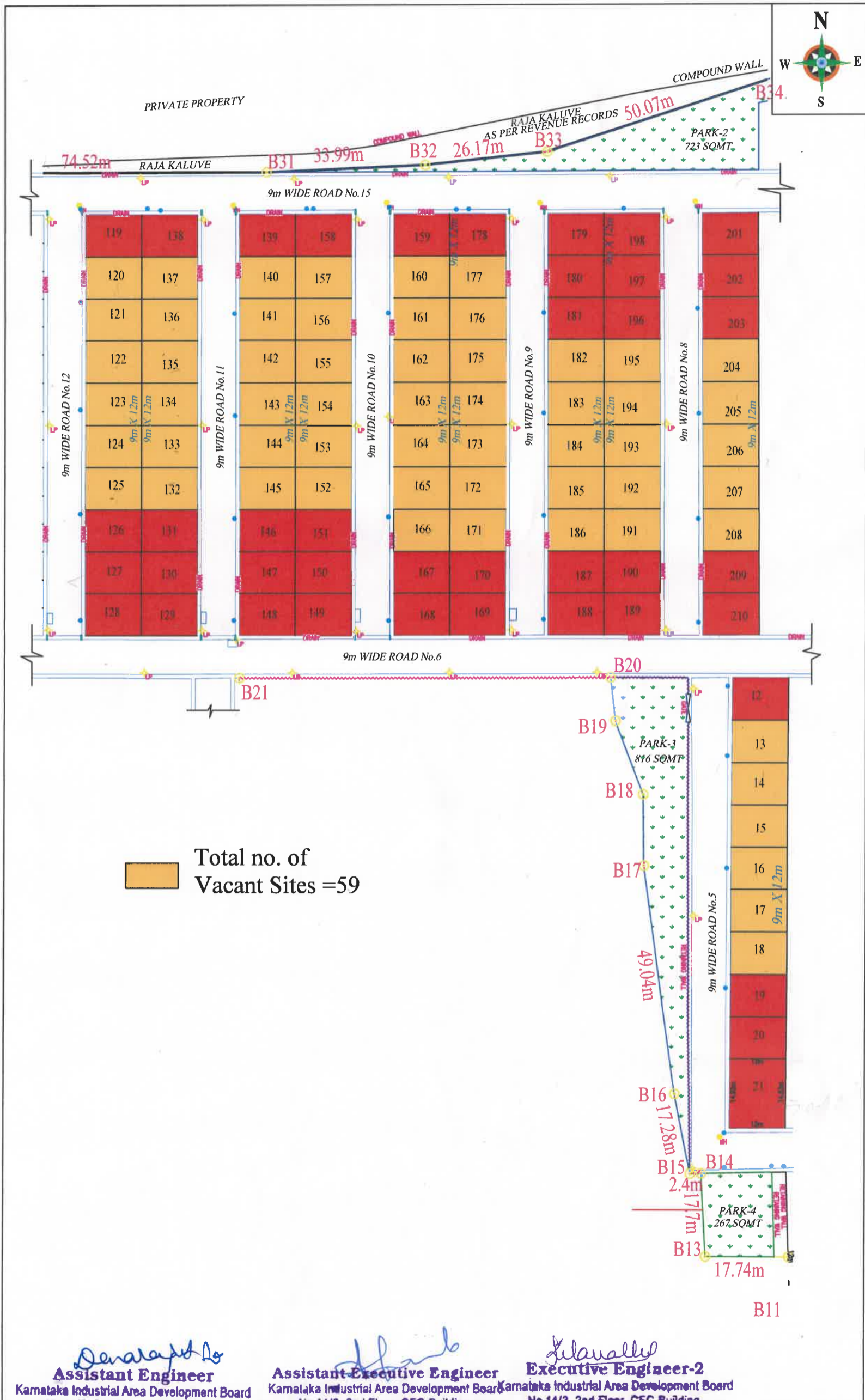

 Total no. of Vacant Sites = 59

Sanat Kumar
Assistant Engineer
 Karnataka Industrial Area Development Board
 No.14/3, 2nd Floor, CFC Building,
 Maharshi Aravinda Bhavan, Nrupatunga Road,
 Bangalore (Karnataka) - 560 001

Shankar
Assistant Executive Engineer
 Karnataka Industrial Area Development Board
 No.14/3, 2nd Floor, CFC Building,
 Maharshi Aravinda Bhavan, Nrupatunga Road,
 Bangalore (Karnataka) - 560 001

Silavally
Executive Engineer-2
 Karnataka Industrial Area Development Board
 No.14/3, 2nd Floor, CFC Building,
 Maharshi Aravinda Bhavan, Nrupatunga Road,
 Bangalore (Karnataka) - 560 001

6*9

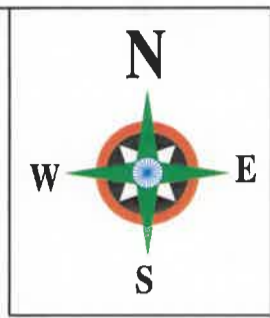

Total no. of EWS Vacant Sites = 54
 Total no. of Odd Vacant Sites = 12

Senevindu
Assistant Engineer
 Karnataka Industrial Area Development Board
 No.14/3, 2nd Floor, CFC Building,
 Maharshi Aravinda Bhavan, Nrupatunga Road,
 Bangalore (Karnataka) - 560 001

Shankar
Assistant Executive Engineer
 Karnataka Industrial Area Development Board
 No.14/3, 2nd Floor, CFC Building,
 Maharshi Aravinda Bhavan, Nrupatunga Road,
 Bangalore (Karnataka) - 560 001

Silvanalli
Executive Engineer-2
 Karnataka Industrial Area Development Board
 No.14/3, 2nd Floor, CFC Building,
 Maharshi Aravinda Bhavan, Nrupatunga Road,
 Bangalore (Karnataka) - 560 001

(12*18) & (15X24)

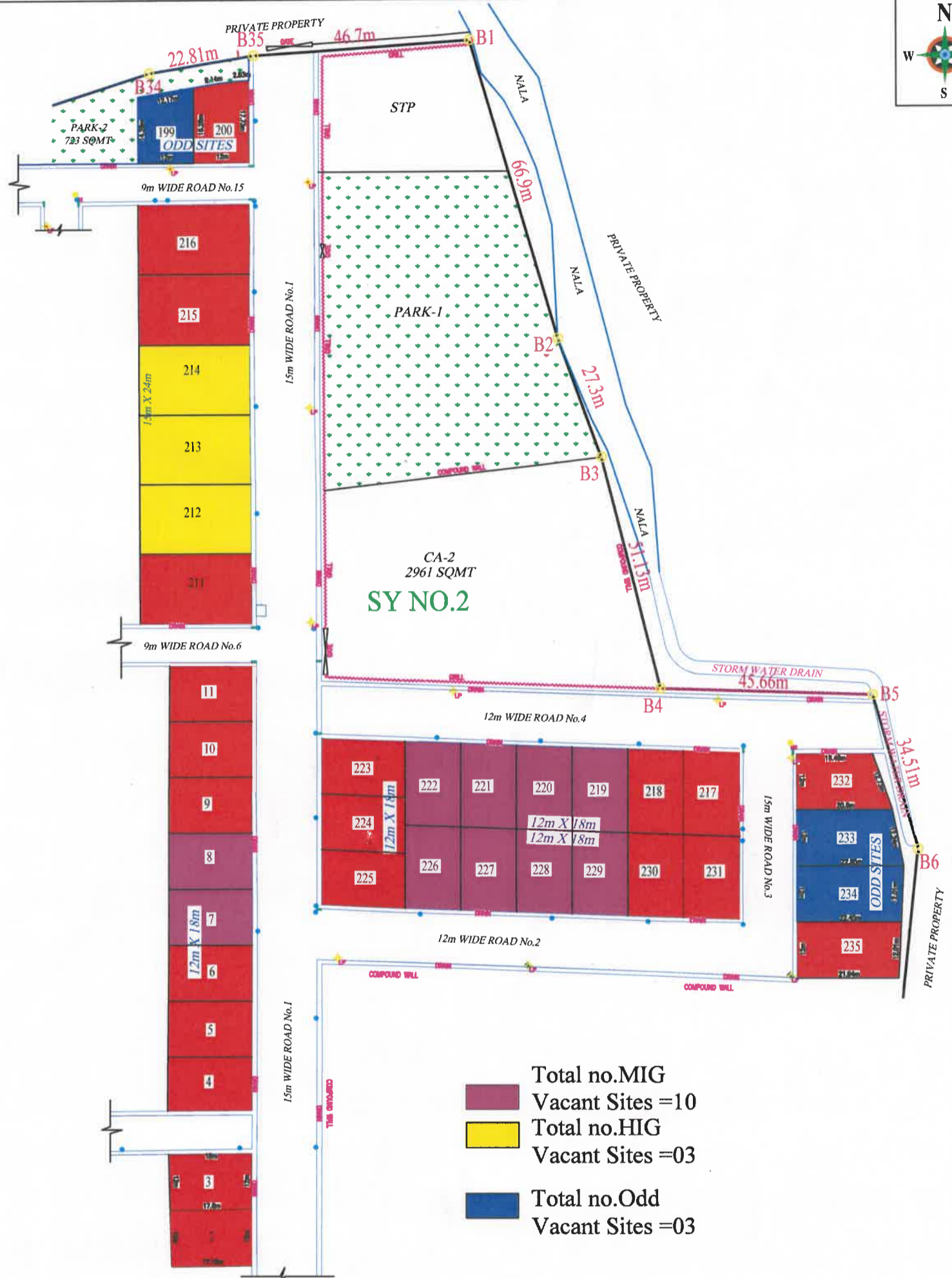

Devalley A
Assistant Engineer
 Kamataka Industrial Area Development Board
 No.14/3, 2nd Floor, CFC Building,
 Maharshi Aravinda Bhavan, Nrupatunga Road,
 Bangalore (Karnataka) - 560 001

Harsh
Assistant Executive Engineer
 Kamataka Industrial Area Development Board
 No.14/3, 2nd Floor, CFC Building,
 Maharshi Aravinda Bhavan, Nrupatunga Road,
 Bangalore (Karnataka) - 560 001

Devalley
Executive Engineer-2
 Kamataka Industrial Area Development Board
 No.14/3, 2nd Floor, CFC Building,
 Maharshi Aravinda Bhavan, Nrupatunga Road,
 Bangalore (Karnataka) - 560 001

ಕರ್ನಾಟಕ ಕೈಗಾರಿಕಾ ಪ್ರದೇಶಾಭಿವೃದ್ಧಿ ಮಂಡಳಿ										
ಮಂಡಳಿಯ ವಸತಿ ಬಡಾವಣೆ										
ಕಾರ್ನರ್ ಮತ್ತು ಸೆಂಟರ್ ಸ್ಟಾಟ್‌ಗಳ ವಿವರಗಳು										
ಇ-ಪರಾಜಿನ ಮೂಲಕ ಹಂಚಿಕೆಗೆ ಲಭ್ಯವಿರುವ ವಸತಿ ಬಡಾವಣೆಗಳ ವಿವರಗಳು										
ಕ್ರಮ ಸಂಖ್ಯೆ	ಪ್ಲಾಟ್ ನಂ/ಸ್ಟಾಟ್ ನಂ	ಪ್ಲಾಟ್ /ಸ್ಟಾಟ್ ಅಳತೆ (ಮೀಟರ್ ಗಳಲ್ಲಿ)		ಪ್ಲಾಟ್ /ಸ್ಟಾಟ್ ವಿಸ್ತೀರ್ಣ (ಚದರ ಮೀಟರ್‌ಗಳಲ್ಲಿ)	ಕಾರ್ನರ್ ಮತ್ತು ಸೆಂಟರ್ ಸ್ಟಾಟ್‌ಗಳ ಸ್ಥಳ	ಪ್ಲಾಟ್ /ಸ್ಟಾಟ್ ದಿಕ್ಕು	ಚಿಕ್ಕುಬಂದಿಗಳು			
		ಪೂರ್ವ - ಪಶ್ಚಿಮ	ಉತ್ತರ-ದಕ್ಷಿಣ				ಪೂರ್ವ	ಪಶ್ಚಿಮ	ಉತ್ತರ	ದಕ್ಷಿಣ
1	2	3	4	5	6	7	8	9	10	11
15 ಮೀ ಅಗಲದ ರಸ್ತೆ										
1	7	18.00	12.00	216.00	ಸೆಂಟರ್	ಪೂರ್ವ	ರಸ್ತೆ	ಪ್ಲಾಟ್ ನಂ. 17 & 18	ಪ್ಲಾಟ್ ನಂ. 8	ಪ್ಲಾಟ್ ನಂ. 6
2	8	18.00	12.00	216.00	ಸೆಂಟರ್	ಪೂರ್ವ	ರಸ್ತೆ	ಪ್ಲಾಟ್ ನಂ. 16 & 17	ಪ್ಲಾಟ್ ನಂ. 9	ಪ್ಲಾಟ್ ನಂ. 7
3	212	24.00	15.00	360.00	ಸೆಂಟರ್	ಪೂರ್ವ	ರಸ್ತೆ	ಪ್ಲಾಟ್ ನಂ. 207, 208 & 209	ಪ್ಲಾಟ್ ನಂ. 213	ಪ್ಲಾಟ್ ನಂ. 211
4	213	24.00	15.00	360.00	ಸೆಂಟರ್	ಪೂರ್ವ	ರಸ್ತೆ	ಪ್ಲಾಟ್ ನಂ.206 & 207	ಪ್ಲಾಟ್ ನಂ. 214	ಪ್ಲಾಟ್ ನಂ. 212
5	214	24.00	15.00	360.00	ಸೆಂಟರ್	ಪೂರ್ವ	ರಸ್ತೆ	ಪ್ಲಾಟ್ ನಂ. 204 & 205	ಪ್ಲಾಟ್ ನಂ. 215	ಪ್ಲಾಟ್ ನಂ. 213
12 ಮೀ ಅಗಲದ ರಸ್ತೆ										
6	219	12.00	18.00	216.00	ಸೆಂಟರ್	ಉತ್ತರ	ಪ್ಲಾಟ್ ನಂ. 218	ಪ್ಲಾಟ್ ನಂ. 220	ರಸ್ತೆ	ಪ್ಲಾಟ್ ನಂ. 229
7	220	12.00	18.00	216.00	ಸೆಂಟರ್	ಉತ್ತರ	ಪ್ಲಾಟ್ ನಂ. 219	ಪ್ಲಾಟ್ ನಂ. 221	ರಸ್ತೆ	ಪ್ಲಾಟ್ ನಂ. 228
8	221	12.00	18.00	216.00	ಸೆಂಟರ್	ಉತ್ತರ	ಪ್ಲಾಟ್ ನಂ. 220	ಪ್ಲಾಟ್ ನಂ. 222	ರಸ್ತೆ	ಪ್ಲಾಟ್ ನಂ. 227
9	222	12.00	18.00	216.00	ಸೆಂಟರ್	ಉತ್ತರ	ಪ್ಲಾಟ್ ನಂ. 221	ಪ್ಲಾಟ್ ನಂ. 223 & 224	ರಸ್ತೆ	ಪ್ಲಾಟ್ ನಂ. 226
10	226	12.00	18.00	216.00	ಸೆಂಟರ್	ದಕ್ಷಿಣ	ಪ್ಲಾಟ್ ನಂ. 227	ಪ್ಲಾಟ್ ನಂ. 224 & 225	ಪ್ಲಾಟ್ ನಂ. 222	ರಸ್ತೆ
11	227	12.00	18.00	216.00	ಸೆಂಟರ್	ದಕ್ಷಿಣ	ಪ್ಲಾಟ್ ನಂ. 228	ಪ್ಲಾಟ್ ನಂ. 226	ಪ್ಲಾಟ್ ನಂ. 221	ರಸ್ತೆ
12	228	12.00	18.00	216.00	ಸೆಂಟರ್	ದಕ್ಷಿಣ	ಪ್ಲಾಟ್ ನಂ. 229	ಪ್ಲಾಟ್ ನಂ. 227	ಪ್ಲಾಟ್ ನಂ. 220	ರಸ್ತೆ
13	229	12.00	18.00	216.00	ಸೆಂಟರ್	ದಕ್ಷಿಣ	ಪ್ಲಾಟ್ ನಂ. 230	ಪ್ಲಾಟ್ ನಂ. 228	ಪ್ಲಾಟ್ ನಂ. 219	ರಸ್ತೆ
14	233	(20.60+22.95)/2	(12+12.24)/2	263.91	ಸೆಂಟರ್	ಪಶ್ಚಿಮ	ಖಾಸಗಿ ಸ್ವತ್ತು	ರಸ್ತೆ	ಪ್ಲಾಟ್ ನಂ. 232	ಪ್ಲಾಟ್ ನಂ. 234
15	234	(22.95+22.45)/2	12.00	272.40	ಸೆಂಟರ್	ಪಶ್ಚಿಮ	ಖಾಸಗಿ ಸ್ವತ್ತು	ರಸ್ತೆ	ಪ್ಲಾಟ್ ನಂ. 233	ಪ್ಲಾಟ್ ನಂ. 235
9 ಮೀ ಅಗಲದ ರಸ್ತೆ										
16	13	12.00	9.00	108.00	ಸೆಂಟರ್	ಪಶ್ಚಿಮ	ಪ್ಲಾಟ್ ನಂ. 10 & 11	ರಸ್ತೆ	ಪ್ಲಾಟ್ ನಂ. 12	ಪ್ಲಾಟ್ ನಂ. 14
17	14	12.00	9.00	108.00	ಸೆಂಟರ್	ಪಶ್ಚಿಮ	ಪ್ಲಾಟ್ ನಂ. 9 & 10	ರಸ್ತೆ	ಪ್ಲಾಟ್ ನಂ. 13	ಪ್ಲಾಟ್ ನಂ. 15
18	15	12.00	9.00	108.00	ಸೆಂಟರ್	ಪಶ್ಚಿಮ	ಪ್ಲಾಟ್ ನಂ. 9	ರಸ್ತೆ	ಪ್ಲಾಟ್ ನಂ. 14	ಪ್ಲಾಟ್ ನಂ. 16

48	164	12.00	9.00	108.00	ಸೆಂಟರ್	ಪಶ್ಚಿಮ	ಪ್ಲಾಟ್ ನಂ. 173	ರಸ್ತೆ	ಪ್ಲಾಟ್ ನಂ. 163	ಪ್ಲಾಟ್ ನಂ. 165
49	165	12.00	9.00	108.00	ಸೆಂಟರ್	ಪಶ್ಚಿಮ	ಪ್ಲಾಟ್ ನಂ.172	ರಸ್ತೆ	ಪ್ಲಾಟ್ ನಂ. 164	ಪ್ಲಾಟ್ ನಂ. 166
50	166	12.00	9.00	108.00	ಸೆಂಟರ್	ಪಶ್ಚಿಮ	ಪ್ಲಾಟ್ ನಂ. 171	ರಸ್ತೆ	ಪ್ಲಾಟ್ ನಂ. 165	ಪ್ಲಾಟ್ ನಂ. 167
51	152	12.00	9.00	108.00	ಸೆಂಟರ್	ಪೂರ್ವ	ರಸ್ತೆ	ಪ್ಲಾಟ್ ನಂ. 145	ಪ್ಲಾಟ್ ನಂ. 153	ಪ್ಲಾಟ್ ನಂ. 151
52	153	12.00	9.00	108.00	ಸೆಂಟರ್	ಪೂರ್ವ	ರಸ್ತೆ	ಪ್ಲಾಟ್ ನಂ. 144	ಪ್ಲಾಟ್ ನಂ. 154	ಪ್ಲಾಟ್ ನಂ. 152
53	154	12.00	9.00	108.00	ಸೆಂಟರ್	ಪೂರ್ವ	ರಸ್ತೆ	ಪ್ಲಾಟ್ ನಂ. 143	ಪ್ಲಾಟ್ ನಂ. 155	ಪ್ಲಾಟ್ ನಂ. 153
54	155	12.00	9.00	108.00	ಸೆಂಟರ್	ಪೂರ್ವ	ರಸ್ತೆ	ಪ್ಲಾಟ್ ನಂ. 142	ಪ್ಲಾಟ್ ನಂ. 156	ಪ್ಲಾಟ್ ನಂ. 154
55	156	12.00	9.00	108.00	ಸೆಂಟರ್	ಪೂರ್ವ	ರಸ್ತೆ	ಪ್ಲಾಟ್ ನಂ.141	ಪ್ಲಾಟ್ ನಂ. 157	ಪ್ಲಾಟ್ ನಂ. 155
56	157	12.00	9.00	108.00	ಸೆಂಟರ್	ಪೂರ್ವ	ರಸ್ತೆ	ಪ್ಲಾಟ್ ನಂ. 140	ಪ್ಲಾಟ್ ನಂ. 158	ಪ್ಲಾಟ್ ನಂ. 156
57	140	12.00	9.00	108.00	ಸೆಂಟರ್	ಪಶ್ಚಿಮ	ಪ್ಲಾಟ್ ನಂ. 157	ರಸ್ತೆ	ಪ್ಲಾಟ್ ನಂ. 139	ಪ್ಲಾಟ್ ನಂ. 141
58	141	12.00	9.00	108.00	ಸೆಂಟರ್	ಪಶ್ಚಿಮ	ಪ್ಲಾಟ್ ನಂ. 156	ರಸ್ತೆ	ಪ್ಲಾಟ್ ನಂ. 140	ಪ್ಲಾಟ್ ನಂ. 142
59	142	12.00	9.00	108.00	ಸೆಂಟರ್	ಪಶ್ಚಿಮ	ಪ್ಲಾಟ್ ನಂ. 155	ರಸ್ತೆ	ಪ್ಲಾಟ್ ನಂ. 141	ಪ್ಲಾಟ್ ನಂ. 143
60	143	12.00	9.00	108.00	ಸೆಂಟರ್	ಪಶ್ಚಿಮ	ಪ್ಲಾಟ್ ನಂ.154	ರಸ್ತೆ	ಪ್ಲಾಟ್ ನಂ. 142	ಪ್ಲಾಟ್ ನಂ. 144
61	144	12.00	9.00	108.00	ಸೆಂಟರ್	ಪಶ್ಚಿಮ	ಪ್ಲಾಟ್ ನಂ.153	ರಸ್ತೆ	ಪ್ಲಾಟ್ ನಂ. 143	ಪ್ಲಾಟ್ ನಂ. 145
62	145	12.00	9.00	108.00	ಸೆಂಟರ್	ಪಶ್ಚಿಮ	ಪ್ಲಾಟ್ ನಂ.152	ರಸ್ತೆ	ಪ್ಲಾಟ್ ನಂ. 144	ಪ್ಲಾಟ್ ನಂ. 146
63	132	12.00	9.00	108.00	ಸೆಂಟರ್	ಪೂರ್ವ	ರಸ್ತೆ	ಪ್ಲಾಟ್ ನಂ. 125	ಪ್ಲಾಟ್ ನಂ. 133	ಪ್ಲಾಟ್ ನಂ. 131
64	133	12.00	9.00	108.00	ಸೆಂಟರ್	ಪೂರ್ವ	ರಸ್ತೆ	ಪ್ಲಾಟ್ ನಂ. 124	ಪ್ಲಾಟ್ ನಂ. 134	ಪ್ಲಾಟ್ ನಂ. 132
65	134	12.00	9.00	108.00	ಸೆಂಟರ್	ಪೂರ್ವ	ರಸ್ತೆ	ಪ್ಲಾಟ್ ನಂ. 123	ಪ್ಲಾಟ್ ನಂ. 135	ಪ್ಲಾಟ್ ನಂ. 133
66	135	12.00	9.00	108.00	ಸೆಂಟರ್	ಪೂರ್ವ	ರಸ್ತೆ	ಪ್ಲಾಟ್ ನಂ. 122	ಪ್ಲಾಟ್ ನಂ. 136	ಪ್ಲಾಟ್ ನಂ. 134
67	136	12.00	9.00	108.00	ಸೆಂಟರ್	ಪೂರ್ವ	ರಸ್ತೆ	ಪ್ಲಾಟ್ ನಂ. 121	ಪ್ಲಾಟ್ ನಂ. 137	ಪ್ಲಾಟ್ ನಂ. 135
68	137	12.00	9.00	108.00	ಸೆಂಟರ್	ಪೂರ್ವ	ರಸ್ತೆ	ಪ್ಲಾಟ್ ನಂ. 120	ಪ್ಲಾಟ್ ನಂ. 138	ಪ್ಲಾಟ್ ನಂ. 136
69	120	12.00	9.00	108.00	ಸೆಂಟರ್	ಪಶ್ಚಿಮ	ಪ್ಲಾಟ್ ನಂ. 137	ರಸ್ತೆ	ಪ್ಲಾಟ್ ನಂ. 119	ಪ್ಲಾಟ್ ನಂ. 121
70	121	12.00	9.00	108.00	ಸೆಂಟರ್	ಪಶ್ಚಿಮ	ಪ್ಲಾಟ್ ನಂ.136	ರಸ್ತೆ	ಪ್ಲಾಟ್ ನಂ. 120	ಪ್ಲಾಟ್ ನಂ. 122
71	122	12.00	9.00	108.00	ಸೆಂಟರ್	ಪಶ್ಚಿಮ	ಪ್ಲಾಟ್ ನಂ.135	ರಸ್ತೆ	ಪ್ಲಾಟ್ ನಂ. 121	ಪ್ಲಾಟ್ ನಂ. 123
72	123	12.00	9.00	108.00	ಸೆಂಟರ್	ಪಶ್ಚಿಮ	ಪ್ಲಾಟ್ ನಂ.134	ರಸ್ತೆ	ಪ್ಲಾಟ್ ನಂ. 122	ಪ್ಲಾಟ್ ನಂ. 124
73	124	12.00	9.00	108.00	ಸೆಂಟರ್	ಪಶ್ಚಿಮ	ಪ್ಲಾಟ್ ನಂ. 133	ರಸ್ತೆ	ಪ್ಲಾಟ್ ನಂ. 123	ಪ್ಲಾಟ್ ನಂ. 125
74	125	12.00	9.00	108.00	ಸೆಂಟರ್	ಪಶ್ಚಿಮ	ಪ್ಲಾಟ್ ನಂ.132	ರಸ್ತೆ	ಪ್ಲಾಟ್ ನಂ. 124	ಪ್ಲಾಟ್ ನಂ. 126
75	108	9.00	6.00	54.00	ಸೆಂಟರ್	ಪೂರ್ವ	ರಸ್ತೆ	ಪ್ಲಾಟ್ ನಂ. 99	ಪ್ಲಾಟ್ ನಂ. 109	ಪ್ಲಾಟ್ ನಂ. 107

115	46	$(9.05+7.99)/2$	$(6.0+6.08)/2$	51.46	ಸೆಂಟರ್	ಪೂರ್ವ	ರಸ್ತೆ	ಖಾಸಗಿ ಸ್ವತ್ತು	ಪ್ಲಾಟ್ ನಂ. 47	ಪ್ಲಾಟ್ ನಂ. 45
116	47	$(9.49+9.05)/2$	$(6.0+6.04)/2$	55.81	ಸೆಂಟರ್	ಪೂರ್ವ	ರಸ್ತೆ	ಖಾಸಗಿ ಸ್ವತ್ತು	ಪ್ಲಾಟ್ ನಂ. 48	ಪ್ಲಾಟ್ ನಂ. 46
117	48	$(9.38+9.49)/2$	6.00	56.58	ಸೆಂಟರ್	ಪೂರ್ವ	ರಸ್ತೆ	ಖಾಸಗಿ ಸ್ವತ್ತು	ಪ್ಲಾಟ್ ನಂ. 49	ಪ್ಲಾಟ್ ನಂ. 47
118	49	$(9.26+9.38)/2$	6.00	55.92	ಸೆಂಟರ್	ಪೂರ್ವ	ರಸ್ತೆ	ಖಾಸಗಿ ಸ್ವತ್ತು	ಪ್ಲಾಟ್ ನಂ. 50	ಪ್ಲಾಟ್ ನಂ. 48
119	50	$(9.13+9.26)/2$	6.00	55.14	ಸೆಂಟರ್	ಪೂರ್ವ	ರಸ್ತೆ	ಖಾಸಗಿ ಸ್ವತ್ತು	ಪ್ಲಾಟ್ ನಂ. 51	ಪ್ಲಾಟ್ ನಂ. 49
120	51	$(9.01+9.13)/2$	6.00	54.42	ಸೆಂಟರ್	ಪೂರ್ವ	ರಸ್ತೆ	ಖಾಸಗಿ ಸ್ವತ್ತು	ಪ್ಲಾಟ್ ನಂ. 52	ಪ್ಲಾಟ್ ನಂ. 50
121	52	$(8.89+9.01)/2$	6.00	53.70	ಸೆಂಟರ್	ಪೂರ್ವ	ರಸ್ತೆ	ಖಾಸಗಿ ಸ್ವತ್ತು	ಪ್ಲಾಟ್ ನಂ. 53	ಪ್ಲಾಟ್ ನಂ. 51
122	53	$(8.7+8.89)/2$	6.00	52.77	ಸೆಂಟರ್	ಪೂರ್ವ	ರಸ್ತೆ	ಖಾಸಗಿ ಸ್ವತ್ತು	ಪ್ಲಾಟ್ ನಂ. 54	ಪ್ಲಾಟ್ ನಂ. 52
123	54	$(8.49+8.70)/2$	6.00	51.54	ಸೆಂಟರ್	ಪೂರ್ವ	ರಸ್ತೆ	ಖಾಸಗಿ ಸ್ವತ್ತು	ಪ್ಲಾಟ್ ನಂ. 55	ಪ್ಲಾಟ್ ನಂ. 53
124	55	$(8.28+8.49)/2$	6.00	50.28	ಸೆಂಟರ್	ಪೂರ್ವ	ರಸ್ತೆ	ಖಾಸಗಿ ಸ್ವತ್ತು	ಪ್ಲಾಟ್ ನಂ. 56	ಪ್ಲಾಟ್ ನಂ. 54
125	56	$(8.07+8.28)/2$	6.00	49.02	ಸೆಂಟರ್	ಪೂರ್ವ	ರಸ್ತೆ	ಖಾಸಗಿ ಸ್ವತ್ತು	ಪ್ಲಾಟ್ ನಂ. 57	ಪ್ಲಾಟ್ ನಂ. 55
126	57	$(7.87+8.07)/2$	6.00	47.82	ಸೆಂಟರ್	ಪೂರ್ವ	ರಸ್ತೆ	ಖಾಸಗಿ ಸ್ವತ್ತು	ಪ್ಲಾಟ್ ನಂ. 58	ಪ್ಲಾಟ್ ನಂ. 56
127	34	6.00	9.00	54.00	ಸೆಂಟರ್	ಉತ್ತರ	ಪ್ಲಾಟ್ ನಂ. 33	ಪ್ಲಾಟ್ ನಂ. 35	ರಸ್ತೆ	ಪ್ಲಾಟ್ ನಂ. 31
128	35	6.00	9.00	54.00	ಸೆಂಟರ್	ಉತ್ತರ	ಪ್ಲಾಟ್ ನಂ. 34	ಪ್ಲಾಟ್ ನಂ. 36	ರಸ್ತೆ	ಪ್ಲಾಟ್ ನಂ. 30
129	36	6.00	9.00	54.00	ಸೆಂಟರ್	ಉತ್ತರ	ಪ್ಲಾಟ್ ನಂ. 35	ಪ್ಲಾಟ್ ನಂ. 37	ರಸ್ತೆ	ಪ್ಲಾಟ್ ನಂ. 29
130	37	6.00	9.00	54.00	ಸೆಂಟರ್	ಉತ್ತರ	ಪ್ಲಾಟ್ ನಂ. 36	ಪ್ಲಾಟ್ ನಂ. 38	ರಸ್ತೆ	ಪ್ಲಾಟ್ ನಂ. 28
131	38	6.00	9.00	54.00	ಸೆಂಟರ್	ಉತ್ತರ	ಪ್ಲಾಟ್ ನಂ. 37	ಪ್ಲಾಟ್ ನಂ. 39	ರಸ್ತೆ	ಪ್ಲಾಟ್ ನಂ. 27
132	39	6.00	9.00	54.00	ಸೆಂಟರ್	ಉತ್ತರ	ಪ್ಲಾಟ್ ನಂ. 38	ಪ್ಲಾಟ್ ನಂ. 40	ರಸ್ತೆ	ಪ್ಲಾಟ್ ನಂ. 26
133	40	6.00	9.00	54.00	ಸೆಂಟರ್	ಉತ್ತರ	ಪ್ಲಾಟ್ ನಂ. 39	ಪ್ಲಾಟ್ ನಂ. 41	ರಸ್ತೆ	ಪ್ಲಾಟ್ ನಂ. 25
134	25	6.00	9.00	54.00	ಸೆಂಟರ್	ದಕ್ಷಿಣ	ಪ್ಲಾಟ್ ನಂ. 26	ಪ್ಲಾಟ್ ನಂ. 24	ಪ್ಲಾಟ್ ನಂ. 40	ರಸ್ತೆ
135	26	6.00	9.00	54.00	ಸೆಂಟರ್	ದಕ್ಷಿಣ	ಪ್ಲಾಟ್ ನಂ. 27	ಪ್ಲಾಟ್ ನಂ. 25	ಪ್ಲಾಟ್ ನಂ. 39	ರಸ್ತೆ
136	27	6.00	9.00	54.00	ಸೆಂಟರ್	ದಕ್ಷಿಣ	ಪ್ಲಾಟ್ ನಂ. 28	ಪ್ಲಾಟ್ ನಂ. 26	ಪ್ಲಾಟ್ ನಂ. 38	ರಸ್ತೆ
137	28	6.00	9.00	54.00	ಸೆಂಟರ್	ದಕ್ಷಿಣ	ಪ್ಲಾಟ್ ನಂ. 29	ಪ್ಲಾಟ್ ನಂ. 27	ಪ್ಲಾಟ್ ನಂ. 37	ರಸ್ತೆ
138	29	6.00	9.00	54.00	ಸೆಂಟರ್	ದಕ್ಷಿಣ	ಪ್ಲಾಟ್ ನಂ. 30	ಪ್ಲಾಟ್ ನಂ. 28	ಪ್ಲಾಟ್ ನಂ. 36	ರಸ್ತೆ
139	30	6.00	9.00	54.00	ಸೆಂಟರ್	ದಕ್ಷಿಣ	ಪ್ಲಾಟ್ ನಂ. 31	ಪ್ಲಾಟ್ ನಂ. 29	ಪ್ಲಾಟ್ ನಂ. 35	ರಸ್ತೆ
140	31	6.00	9.00	54.00	ಸೆಂಟರ್	ದಕ್ಷಿಣ	ಪ್ಲಾಟ್ ನಂ. 32	ಪ್ಲಾಟ್ ನಂ. 30	ಪ್ಲಾಟ್ ನಂ. 34	ರಸ್ತೆ
141	199	$(12+12.17)/2$	$(14.26+16.26)/2$	184.42	ಸೆಂಟರ್	ದಕ್ಷಿಣ	ಪ್ಲಾಟ್ ನಂ. 200	ಪಾರ್ಕ್	ಖಾಸಗಿ ಸ್ವತ್ತು	ರಸ್ತೆ

KARNATAKA INDUSTRIAL AREAS DEVELOPMENT BOARD

Housing Layout

Details of Corner & Center Plots

Details of Plots Available Corner & Center Plots for allotment in E-Auction

Sl. No.	Plot No.	Plot Measurements (in Mtr)		Extent of the Plot (in Sqm)	Place of Corner/ Center Plot	Plot Directions	Boundaries			
		East - West	North - South				East	West	North	South
1	2	3	4	5	6	7	8	9	10	11
15 Mtr Wide Road										
1	7	18.00	12.00	216.00	Center	East	Road	Plot No. 17 & 18	Plot No. 8	Plot No. 6
2	8	18.00	12.00	216.00	Center	East	Road	Plot No. 16 & 17	Plot No. 9	Plot No. 7
3	212	24.00	15.00	360.00	Center	East	Road	Plot No. 207, 208 & 209	Plot No. 213	Plot No. 211
4	213	24.00	15.00	360.00	Center	East	Road	Plot No. 206 & 207	Plot No. 214	Plot No. 212
5	214	24.00	15.00	360.00	Center	East	Road	Plot No. 204 & 205	Plot No. 215	Plot No. 213
12 Mtr Wide Road										
6	219	12.00	18.00	216.00	Center	North	Plot No. 218	Plot No. 220	Road	Plot No. 229
7	220	12.00	18.00	216.00	Center	North	Plot No. 219	Plot No. 221	Road	Plot No. 228
8	221	12.00	18.00	216.00	Center	North	Plot No. 220	Plot No. 222	Road	Plot No. 227
9	222	12.00	18.00	216.00	Center	North	Plot No. 221	Plot No. 223 & 224	Road	Plot No. 226
10	226	12.00	18.00	216.00	Center	South	Plot No. 227	Plot No. 224 & 225	Plot No. 222	Road
11	227	12.00	18.00	216.00	Center	South	Plot No. 228	Plot No. 226	Plot No. 221	Road
12	228	12.00	18.00	216.00	Center	South	Plot No. 229	Plot No. 227	Plot No. 220	Road
13	229	12.00	18.00	216.00	Center	South	Plot No. 230	Plot No. 228	Plot No. 219	Road
14	233	(20.60+22.95)/2	(12+12.24)/2	263.91	Center	West	Private Property	Road	Plot No. 232	Plot No. 234
15	234	(22.95+22.45)/2	12.00	272.40	Center	West	Private Property	Road	Plot No. 233	Plot No. 235
9 Mtr Wide Road										
16	13	12.00	9.00	108.00	Center	West	Plot No. 10 & 11	Road	Plot No. 12	Plot No. 14
17	14	12.00	9.00	108.00	Center	West	Plot No. 9 & 10	Road	Plot No. 13	Plot No. 15
18	15	12.00	9.00	108.00	Center	West	Plot No. 9	Road	Plot No. 14	Plot No. 16
19	16	12.00	9.00	108.00	Center	West	Plot No. 8	Road	Plot No. 15	Plot No. 17
20	17	12.00	9.00	108.00	Center	West	Plot No. 7 & 8	Road	Plot No. 16	Plot No. 18
21	18	12.00	9.00	108.00	Center	West	Plot No. 6 & 7	Road	Plot No. 17	Plot No. 19
22	204	12.00	9.00	108.00	Center	West	Plot No. 215 & 214	Road	Plot No. 203	Plot No. 205
23	205	12.00	9.00	108.00	Center	West	Plot No. 214	Road	Plot No. 204	Plot No. 206
24	206	12.00	9.00	108.00	Center	West	Plot No. 213	Road	Plot No. 205	Plot No. 207
25	207	12.00	9.00	108.00	Center	West	Plot No. 212 & 213	Road	Plot No. 206	Plot No. 208
26	208	12.00	9.00	108.00	Center	West	Plot No. 212	Road	Plot No. 207	Plot No. 209
27	191	12.00	9.00	108.00	Center	East	Road	Plot No. 186	Plot No. 192	Plot No. 190
28	192	12.00	9.00	108.00	Center	East	Road	Plot No. 185	Plot No. 193	Plot No. 191
29	193	12.00	9.00	108.00	Center	East	Road	Plot No. 184	Plot No. 194	Plot No. 192
30	194	12.00	9.00	108.00	Center	East	Road	Plot No. 183	Plot No. 195	Plot No. 193
31	195	12.00	9.00	108.00	Center	East	Road	Plot No. 182	Plot No. 196	Plot No. 194
32	182	12.00	9.00	108.00	Center	West	Plot No. 195	Road	Plot No. 181	Plot No. 183
33	183	12.00	9.00	108.00	Center	West	Plot No. 194	Road	Plot No. 182	Plot No. 184
34	184	12.00	9.00	108.00	Center	West	Plot No. 193	Road	Plot No. 183	Plot No. 185
35	185	12.00	9.00	108.00	Center	West	Plot No. 192	Road	Plot No. 184	Plot No. 186
36	186	12.00	9.00	108.00	Center	West	Plot No. 191	Road	Plot No. 185	Plot No. 187
37	171	12.00	9.00	108.00	Center	East	Road	Plot No. 166	Plot No. 172	Plot No. 170
38	172	12.00	9.00	108.00	Center	East	Road	Plot No. 165	Plot No. 173	Plot No. 171
39	173	12.00	9.00	108.00	Center	East	Road	Plot No. 164	Plot No. 174	Plot No. 172
40	174	12.00	9.00	108.00	Center	East	Road	Plot No. 163	Plot No. 175	Plot No. 173
41	175	12.00	9.00	108.00	Center	East	Road	Plot No. 162	Plot No. 176	Plot No. 174
42	176	12.00	9.00	108.00	Center	East	Road	Plot No. 161	Plot No. 177	Plot No. 175

43	177	12.00	9.00	108.00	Center	East	Road	Plot No. 160	Plot No. 178	Plot No. 176
44	160	12.00	9.00	108.00	Center	West	Plot No. 177	Road	Plot No. 159	Plot No. 161
45	161	12.00	9.00	108.00	Center	West	Plot No. 176	Road	Plot No. 160	Plot No. 162
46	162	12.00	9.00	108.00	Center	West	Plot No. 175	Road	Plot No. 161	Plot No. 163
47	163	12.00	9.00	108.00	Center	West	Plot No. 174	Road	Plot No. 162	Plot No. 164
48	164	12.00	9.00	108.00	Center	West	Plot No. 173	Road	Plot No. 163	Plot No. 165
49	165	12.00	9.00	108.00	Center	West	Plot No. 172	Road	Plot No. 164	Plot No. 166
50	166	12.00	9.00	108.00	Center	West	Plot No. 171	Road	Plot No. 165	Plot No. 167
51	152	12.00	9.00	108.00	Center	East	Road	Plot No. 145	Plot No. 153	Plot No. 151
52	153	12.00	9.00	108.00	Center	East	Road	Plot No. 144	Plot No. 154	Plot No. 152
53	154	12.00	9.00	108.00	Center	East	Road	Plot No. 143	Plot No. 155	Plot No. 153
54	155	12.00	9.00	108.00	Center	East	Road	Plot No. 142	Plot No. 156	Plot No. 154
55	156	12.00	9.00	108.00	Center	East	Road	Plot No. 141	Plot No. 157	Plot No. 155
56	157	12.00	9.00	108.00	Center	East	Road	Plot No. 140	Plot No. 158	Plot No. 156
57	140	12.00	9.00	108.00	Center	West	Plot No. 157	Road	Plot No. 139	Plot No. 141
58	141	12.00	9.00	108.00	Center	West	Plot No. 156	Road	Plot No. 140	Plot No. 142
59	142	12.00	9.00	108.00	Center	West	Plot No. 155	Road	Plot No. 141	Plot No. 143
60	143	12.00	9.00	108.00	Center	West	Plot No. 154	Road	Plot No. 142	Plot No. 144
61	144	12.00	9.00	108.00	Center	West	Plot No. 153	Road	Plot No. 143	Plot No. 145
62	145	12.00	9.00	108.00	Center	West	Plot No. 152	Road	Plot No. 144	Plot No. 146
63	132	12.00	9.00	108.00	Center	East	Road	Plot No. 125	Plot No. 133	Plot No. 131
64	133	12.00	9.00	108.00	Center	East	Road	Plot No. 124	Plot No. 134	Plot No. 132
65	134	12.00	9.00	108.00	Center	East	Road	Plot No. 123	Plot No. 135	Plot No. 133
66	135	12.00	9.00	108.00	Center	East	Road	Plot No. 122	Plot No. 136	Plot No. 134
67	136	12.00	9.00	108.00	Center	East	Road	Plot No. 121	Plot No. 137	Plot No. 135
68	137	12.00	9.00	108.00	Center	East	Road	Plot No. 120	Plot No. 138	Plot No. 136
69	120	12.00	9.00	108.00	Center	West	Plot No. 137	Road	Plot No. 119	Plot No. 121
70	121	12.00	9.00	108.00	Center	West	Plot No. 136	Road	Plot No. 120	Plot No. 122
71	122	12.00	9.00	108.00	Center	West	Plot No. 135	Road	Plot No. 121	Plot No. 123
72	123	12.00	9.00	108.00	Center	West	Plot No. 134	Road	Plot No. 122	Plot No. 124
73	124	12.00	9.00	108.00	Center	West	Plot No. 133	Road	Plot No. 123	Plot No. 125
74	125	12.00	9.00	108.00	Center	West	Plot No. 132	Road	Plot No. 124	Plot No. 126
75	108	9.00	6.00	54.00	Center	East	Road	Plot No. 99	Plot No. 109	Plot No. 107
76	109	9.00	6.00	54.00	Center	East	Road	Plot No. 98	Plot No. 110	Plot No. 108
77	110	9.00	6.00	54.00	Center	East	Road	Plot No. 97	Plot No. 111	Plot No. 109
78	111	9.00	6.00	54.00	Center	East	Road	Plot No. 96	Plot No. 112	Plot No. 110
79	112	9.00	6.00	54.00	Center	East	Road	Plot No. 95	Plot No. 113	Plot No. 111
80	113	9.00	6.00	54.00	Center	East	Road	Plot No. 94	Plot No. 114	Plot No. 112
81	114	9.00	6.00	54.00	Center	East	Road	Plot No. 93	Plot No. 115	Plot No. 113
82	115	9.00	6.00	54.00	Center	East	Road	Plot No. 92	Plot No. 116	Plot No. 114
83	116	9.00	6.00	54.00	Center	East	Road	Plot No. 91	Plot No. 117	Plot No. 115
84	117	9.00	6.00	54.00	Center	East	Road	Plot No. 90	Plot No. 118	Plot No. 116
85	90	9.00	6.00	54.00	Center	West	Plot No. 117	Road	Plot No. 89	Plot No. 91
86	91	9.00	6.00	54.00	Center	West	Plot No. 116	Road	Plot No. 90	Plot No. 92
87	92	9.00	6.00	54.00	Center	West	Plot No. 115	Road	Plot No. 91	Plot No. 93
88	93	9.00	6.00	54.00	Center	West	Plot No. 114	Road	Plot No. 92	Plot No. 94
89	94	9.00	6.00	54.00	Center	West	Plot No. 113	Road	Plot No. 93	Plot No. 95
90	95	9.00	6.00	54.00	Center	West	Plot No. 112	Road	Plot No. 94	Plot No. 96
91	96	9.00	6.00	54.00	Center	West	Plot No. 111	Road	Plot No. 95	Plot No. 97
92	97	9.00	6.00	54.00	Center	West	Plot No. 110	Road	Plot No. 96	Plot No. 98
93	98	9.00	6.00	54.00	Center	West	Plot No. 109	Road	Plot No. 97	Plot No. 99
94	99	9.00	6.00	54.00	Center	West	Plot No. 108	Road	Plot No. 98	Plot No. 100
95	78	9.00	6.00	54.00	Center	East	Road	Plot No. 69	Plot No. 79	Plot No. 77
96	79	9.00	6.00	54.00	Center	East	Road	Plot No. 68	Plot No. 80	Plot No. 78
97	80	9.00	6.00	54.00	Center	East	Road	Plot No. 67	Plot No. 81	Plot No. 79
98	81	9.00	6.00	54.00	Center	East	Road	Plot No. 66	Plot No. 82	Plot No. 80
99	82	9.00	6.00	54.00	Center	East	Road	Plot No. 65	Plot No. 83	Plot No. 81

100	83	9.00	6.00	54.00	Center	East	Road	Plot No. 64	Plot No. 84	Plot No. 82
101	84	9.00	6.00	54.00	Center	East	Road	Plot No. 63	Plot No. 85	Plot No. 83
102	85	9.00	6.00	54.00	Center	East	Road	Plot No. 62	Plot No. 86	Plot No. 84
103	86	9.00	6.00	54.00	Center	East	Road	Plot No. 61	Plot No. 87	Plot No. 85
104	87	9.00	6.00	54.00	Center	East	Road	Plot No. 60	Plot No. 88	Plot No. 86
105	60	9.00	6.00	54.00	Center	West	Plot No. 87	Road	Plot No. 59	Plot No. 61
106	61	9.00	6.00	54.00	Center	West	Plot No. 86	Road	Plot No. 60	Plot No. 62
107	62	9.00	6.00	54.00	Center	West	Plot No. 85	Road	Plot No. 61	Plot No. 63
108	63	9.00	6.00	54.00	Center	West	Plot No. 84	Road	Plot No. 62	Plot No. 64
109	64	9.00	6.00	54.00	Center	West	Plot No. 83	Road	Plot No. 63	Plot No. 65
110	65	9.00	6.00	54.00	Center	West	Plot No. 82	Road	Plot No. 64	Plot No. 66
111	66	9.00	6.00	54.00	Center	West	Plot No. 81	Road	Plot No. 65	Plot No. 67
112	67	9.00	6.00	54.00	Center	West	Plot No. 80	Road	Plot No. 66	Plot No. 68
113	68	9.00	6.00	54.00	Center	West	Plot No. 79	Road	Plot No. 67	Plot No. 69
114	69	9.00	6.00	54.00	Center	West	Plot No. 78	Road	Plot No. 68	Plot No. 70
115	46	(9.05+7.99)/2	(6.0+6.08)/2	51.46	Center	East	Road	Private Property	Plot No. 47	Plot No. 45
116	47	(9.49+9.05)/2	(6.0+6.04)/2	55.81	Center	East	Road	Private Property	Plot No. 48	Plot No. 46
117	48	(9.38+9.49)/2	6.00	56.58	Center	East	Road	Private Property	Plot No. 49	Plot No. 47
118	49	(9.26+9.38)/2	6.00	55.92	Center	East	Road	Private Property	Plot No. 50	Plot No. 48
119	50	(9.13+9.26)/2	6.00	55.14	Center	East	Road	Private Property	Plot No. 51	Plot No. 49
120	51	(9.01+9.13)/2	6.00	54.42	Center	East	Road	Private Property	Plot No. 52	Plot No. 50
121	52	(8.89+9.01)/2	6.00	53.70	Center	East	Road	Private Property	Plot No. 53	Plot No. 51
122	53	(8.7+8.89)/2	6.00	52.77	Center	East	Road	Private Property	Plot No. 54	Plot No. 52
123	54	(8.49+8.70)/2	6.00	51.54	Center	East	Road	Private Property	Plot No. 55	Plot No. 53
124	55	(8.28+8.49)/2	6.00	50.28	Center	East	Road	Private Property	Plot No. 56	Plot No. 54
125	56	(8.07+8.28)/2	6.00	49.02	Center	East	Road	Private Property	Plot No. 57	Plot No. 55
126	57	(7.87+8.07)/2	6.00	47.82	Center	East	Road	Private Property	Plot No. 58	Plot No. 56
127	34	6.00	9.00	54.00	Center	North	Plot No. 33	Plot No. 35	Road	Plot No. 31
128	35	6.00	9.00	54.00	Center	North	Plot No. 34	Plot No. 36	Road	Plot No. 30
129	36	6.00	9.00	54.00	Center	North	Plot No. 35	Plot No. 37	Road	Plot No. 29
130	37	6.00	9.00	54.00	Center	North	Plot No. 36	Plot No. 38	Road	Plot No. 28
131	38	6.00	9.00	54.00	Center	North	Plot No. 37	Plot No. 39	Road	Plot No. 27
132	39	6.00	9.00	54.00	Center	North	Plot No. 38	Plot No. 40	Road	Plot No. 26
133	40	6.00	9.00	54.00	Center	North	Plot No. 39	Plot No. 41	Road	Plot No. 25
134	25	6.00	9.00	54.00	Center	South	Plot No. 26	Plot No. 24	Plot No. 40	Road
135	26	6.00	9.00	54.00	Center	South	Plot No. 27	Plot No. 25	Plot No. 39	Road
136	27	6.00	9.00	54.00	Center	South	Plot No. 28	Plot No. 26	Plot No. 38	Road
137	28	6.00	9.00	54.00	Center	South	Plot No. 29	Plot No. 27	Plot No. 37	Road
138	29	6.00	9.00	54.00	Center	South	Plot No. 30	Plot No. 28	Plot No. 36	Road
139	30	6.00	9.00	54.00	Center	South	Plot No. 31	Plot No. 29	Plot No. 35	Road
140	31	6.00	9.00	54.00	Center	South	Plot No. 32	Plot No. 30	Plot No. 34	Road
141	199	(12+12.17)/2	(14.26+16.26)/2	184.42	Center	South	Plot No. 200	Park	Private Property	Road