

LAYOUT OF BAIKAMPADY INDUSTRIAL AREA, MANGALORE

(TOTAL EXTENT 541.49 ACRES)

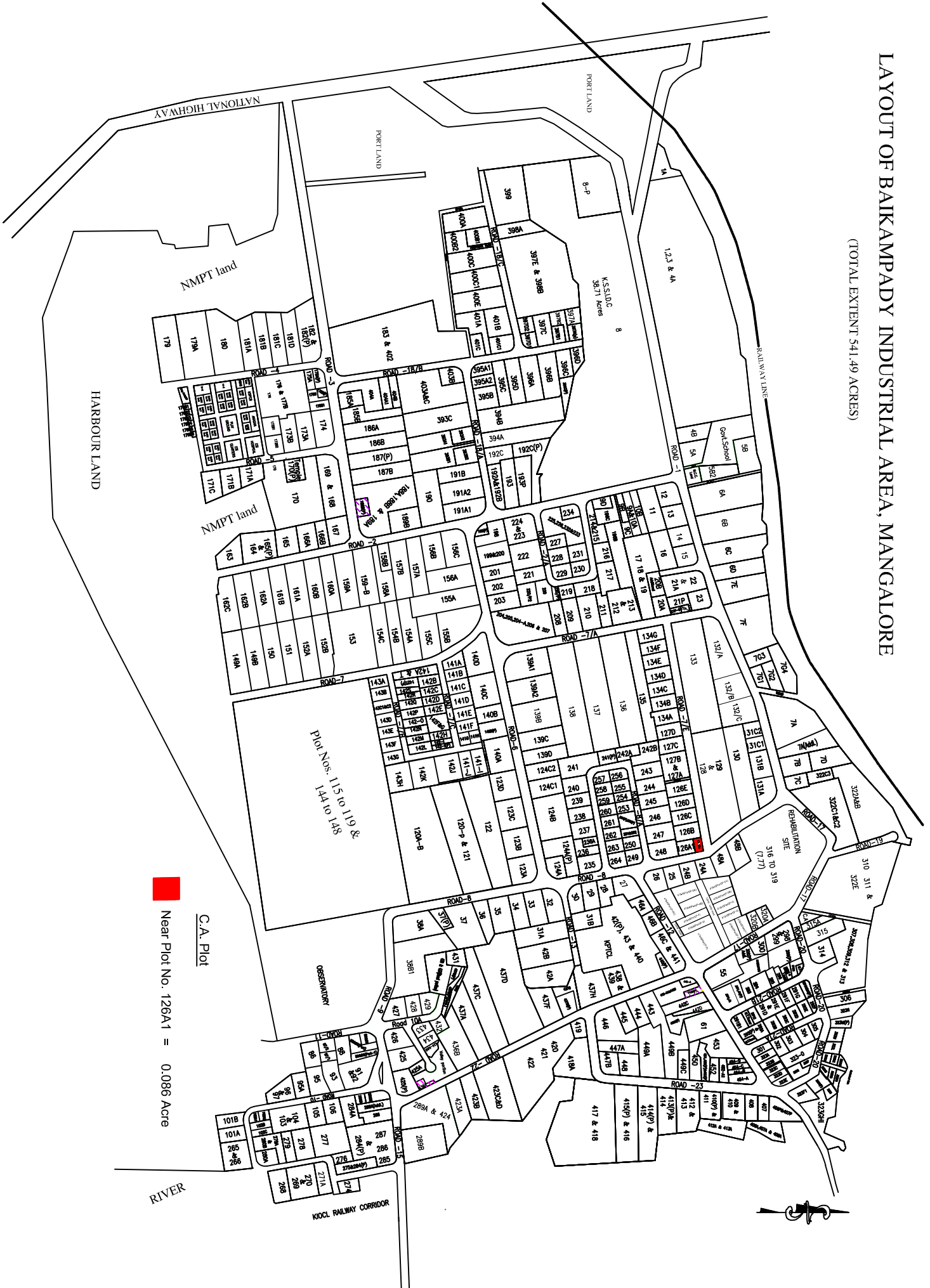

■ Near Plot No. 126A1 = 0.086 Acre

Note : Layout plan approved in the Board meeting dtd. 27-11-1967

LAYOUT MAP OF BELAPU INDUSTRIAL AREA, UDUPI DISTRICT.

(TOTAL EXTENT 68.0 ACRES)

KEY PLAN

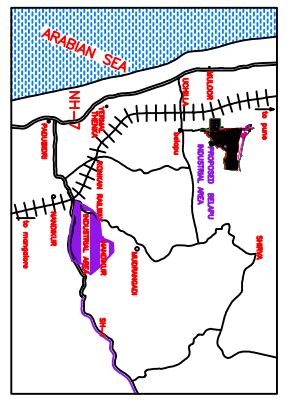
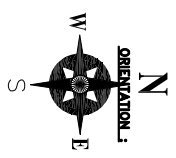

C.A. Plot
 Plot No. A1 - 1.00 Acre
 Plot No. A2 - 0.50 Acre
 Plot No. A3 - 0.50 Acre

LAND USE ANALYSIS

Sl No.	COLOUR	DESCRIPTION	MINIMUM % AS PER NORMS	PROPOSED ARE(Acres)	%
1	INDUSTRIAL & OTHERS	INDUSTRIAL & OTHERS	50% to 60%	37.05	54.48
2	COMMERCIAL	COMMERCIAL	1.92	2.82	57.30
3	ROADS & OTHERS	ROADS	8.24	12.11	
4	PARKS & OPEN AREA	PARKS & OPEN AREA	6.06	8.91	37.61
5	UTILITY	UTILITY	7.80	11.47	
6	AMENITIES & UTILITIES	AMENITIES & UTILITIES	3.48	5.12	
7	GRAND TOTAL		2.00	2.99	5.09
8			1.47	2.16	
9			68.00	100.00	100.00

AMENITIES & UTILITIES

Sl No.	DESCRIPTION	No.s	ARE(Acres)
1	ODD PLOTS	10	2.50
2	ODD PLOTS	10	2.50
3	ODD PLOTS	10	2.50
4	ODD PLOTS	10	2.50
5	ODD PLOTS	10	2.50
6	ODD PLOTS	10	2.50
7	ODD PLOTS	10	2.50
8	ODD PLOTS	10	2.50
9	ODD PLOTS	10	2.50
10	ODD PLOTS	10	2.50
11	ODD PLOTS	10	2.50
12	ODD PLOTS	10	2.50
13	ODD PLOTS	10	2.50
14	ODD PLOTS	10	2.50
15	ODD PLOTS	10	2.50
16	ODD PLOTS	10	2.50
17	ODD PLOTS	10	2.50
18	ODD PLOTS	10	2.50
19	ODD PLOTS	10	2.50
20	ODD PLOTS	10	2.50
21	ODD PLOTS	10	2.50
22	ODD PLOTS	10	2.50
23	ODD PLOTS	10	2.50
24	ODD PLOTS	10	2.50
25	ODD PLOTS	10	2.50
26	ODD PLOTS	10	2.50
27	ODD PLOTS	10	2.50
28	ODD PLOTS	10	2.50
29	ODD PLOTS	10	2.50
30	ODD PLOTS	10	2.50
31	ODD PLOTS	10	2.50
32	ODD PLOTS	10	2.50
33	ODD PLOTS	10	2.50
34	ODD PLOTS	10	2.50
35	ODD PLOTS	10	2.50
36	ODD PLOTS	10	2.50
37	ODD PLOTS	10	2.50
38	ODD PLOTS	10	2.50
39	ODD PLOTS	10	2.50
40	ODD PLOTS	10	2.50
41	ODD PLOTS	10	2.50
42	ODD PLOTS	10	2.50
43	ODD PLOTS	10	2.50
44	ODD PLOTS	10	2.50
45	ODD PLOTS	10	2.50
46	ODD PLOTS	10	2.50
47	ODD PLOTS	10	2.50
48	ODD PLOTS	10	2.50
49	ODD PLOTS	10	2.50
50	ODD PLOTS	10	2.50
51	ODD PLOTS	10	2.50
52	ODD PLOTS	10	2.50
53	ODD PLOTS	10	2.50
54	ODD PLOTS	10	2.50
55	ODD PLOTS	10	2.50
56	ODD PLOTS	10	2.50
57	ODD PLOTS	10	2.50
58	ODD PLOTS	10	2.50
59	ODD PLOTS	10	2.50
60	ODD PLOTS	10	2.50
61	ODD PLOTS	10	2.50
62	ODD PLOTS	10	2.50
63	ODD PLOTS	10	2.50
64	ODD PLOTS	10	2.50
65	ODD PLOTS	10	2.50
66	ODD PLOTS	10	2.50
67	ODD PLOTS	10	2.50
68	ODD PLOTS	10	2.50
69	ODD PLOTS	10	2.50
70	ODD PLOTS	10	2.50
71	ODD PLOTS	10	2.50
72	ODD PLOTS	10	2.50
73	ODD PLOTS	10	2.50
74	ODD PLOTS	10	2.50
75	ODD PLOTS	10	2.50
76	ODD PLOTS	10	2.50
77	ODD PLOTS	10	2.50
78	ODD PLOTS	10	2.50
79	ODD PLOTS	10	2.50
80	ODD PLOTS	10	2.50
81	ODD PLOTS	10	2.50
82	ODD PLOTS	10	2.50
83	ODD PLOTS	10	2.50
84	ODD PLOTS	10	2.50
85	ODD PLOTS	10	2.50
86	ODD PLOTS	10	2.50
87	ODD PLOTS	10	2.50
88	ODD PLOTS	10	2.50
89	ODD PLOTS	10	2.50
90	ODD PLOTS	10	2.50
91	ODD PLOTS	10	2.50
92	ODD PLOTS	10	2.50
93	ODD PLOTS	10	2.50
94	ODD PLOTS	10	2.50
95	ODD PLOTS	10	2.50
96	ODD PLOTS	10	2.50
97	ODD PLOTS	10	2.50
98	ODD PLOTS	10	2.50
99	ODD PLOTS	10	2.50
100	ODD PLOTS	10	2.50

Note: Layout plan approved in the Board meeting dtd. 28-04-2014

PROPOSED INDUSTRIAL AREA BOUNDARY

LEGEND

- INDUSTRIAL & OTHERS
- COMMERCIAL
- ROADS & OTHERS
- PARKS & OPEN AREA
- UTILITY
- AMENITIES & UTILITIES
- PARK
- TRANSPORTATION & TRUCK PARKING
- RWH

GENERAL INFORMATION

CLIENT: GAMMA INFRA TECH

CONSULTANTS: GAMMA INFRA TECH CONSULTANTS & ENGINEERS

PROJECT: LAYOUT MAP OF BELAPU INDUSTRIAL AREA, UDUPI DISTRICT

DATE: 28-04-2014

SCALE: 1:1000

**LAYOUT PLAN SHOWING THE DETAILS OF EPIP INDUSTRIAL AREA, 1st PHASE AT
GANGIMUTTI, MANGALURU TALUK, D.K. DISTRICT.**

TOTAL EXTENT 205.16 ACRES

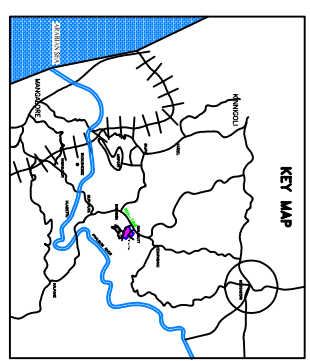

- C.A. Plots**
- Block No. 19 : 1.50 Acres
 - Block No. 23 : 2.00 Acres
 - Block No. 25 : 0.75 Acres

LAYOUT MAP OF MIYAR INDUSTRIAL AREA NEAR KARKALA, UDUPI DISTRICT.

(TOTAL EXTENT 20 ACRES)

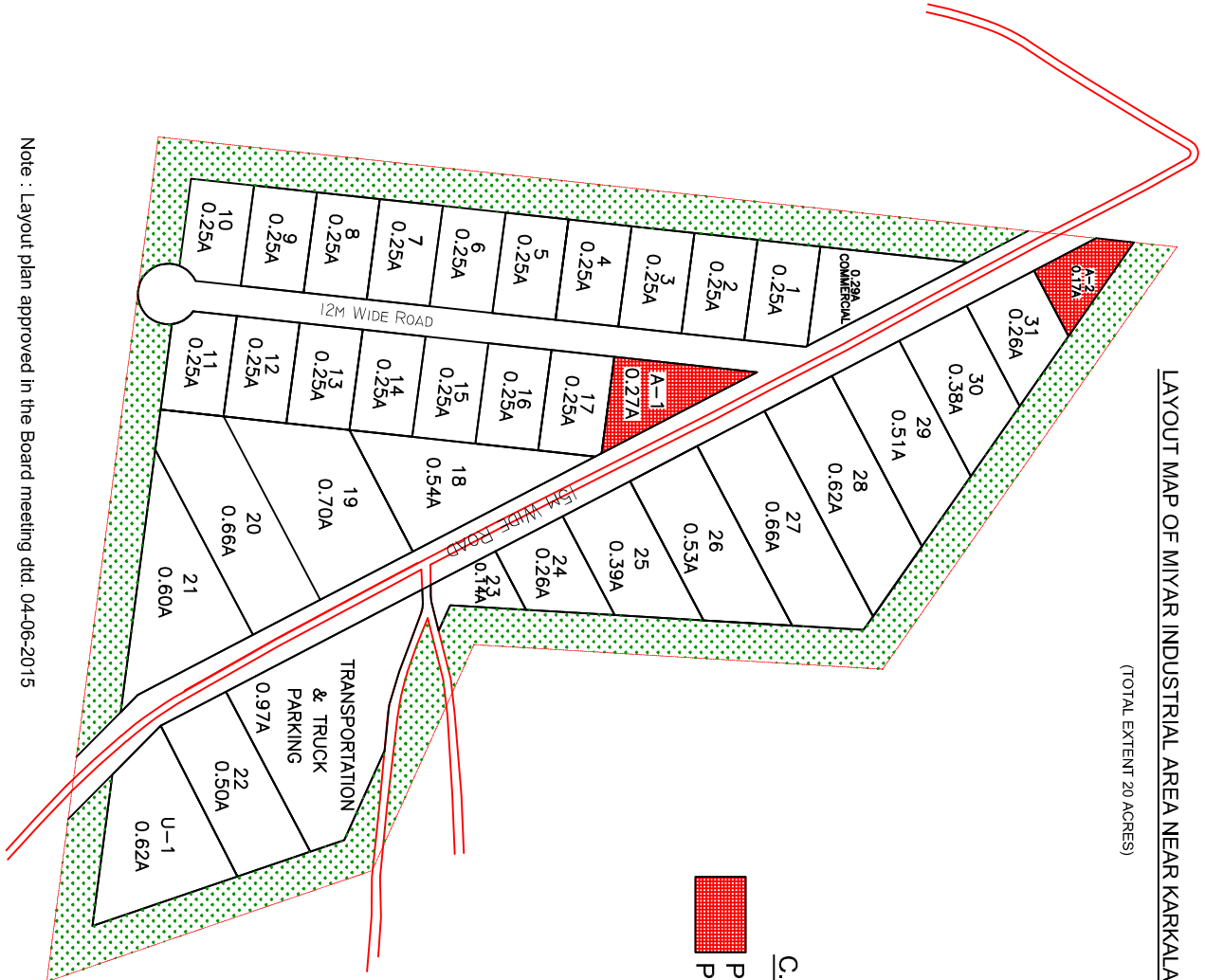

Plot No. A1 : 0.27 Acres
Plot No. A2 : 0.17 Acres

C.A. Plot

KEY PLAN

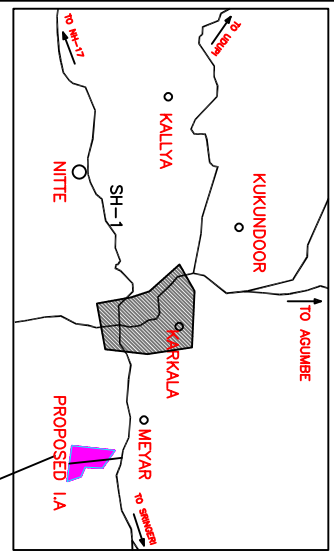

ORIENTATION



LAND USE DETAILS

Sl. No.	DESCRIPTION	Area (Acres)	%
1.	INDUSTRIAL & OTHERS	11.00	55.00
2.	INDUSTRIAL PLOTS	9.00	45.00
3.	COMMERCIAL	0.27	1.35
4.	ROADS & OTHERS	2.88	14.40
5.	ROADS	4.15	20.75
6.	PARKS & OPEN AREA	0.97	4.85
7.	TRUCK PARKING	0.64	3.20
8.	AMENITIES & UTILITIES	0.62	3.10
9.	UTILITIES	0.62	3.10
10.	Grand Total	20.00	100.00

ROADS

Sl. No.	DESCRIPTION	Area (Acres)
1.	INDUSTRIAL & OTHERS	11.00
2.	INDUSTRIAL PLOTS	9.00
3.	COMMERCIAL	0.27
4.	ROADS & OTHERS	2.88
5.	ROADS	4.15
6.	PARKS & OPEN AREA	0.97
7.	TRUCK PARKING	0.64
8.	AMENITIES & UTILITIES	0.62
9.	UTILITIES	0.62
10.	Grand Total	20.00

AMENITIES & UTILITIES

NO.	DESCRIPTION
U-1	DPT & GAS OTHER WATER SUPPLY WORKS ETC.
U-2	SEW & WASTE DISPOSAL
A-1	TELEPHONE EXCHANGE
A-2	RAIL, SHADOW, INDUSTRIES ASSN.
A-3	BUS STAND, POLICE OUTPOST, CLUB OFFICE, POST OFFICE

ROAD DETAILS

Sl. No.	DESCRIPTION	Length (m)
1.	15M WIDE ROAD	472.50
2.	12M WIDE ROAD	262.50
GRAND TOTAL		735.00

Note : Layout plan approved in the Board meeting dtd. 04-06-2015

SCALE : 1 : 2000

SHEET-A1

NOTE: DUE TO SMALL EXTENT OF LAND CANNOT ACCOMMODATE LARGER PLOTS

LEGEND

- Plot Number
- 6.65A - EXTENT
- EXISTING ROAD
- Proposed Industrial Area
- BOUNDARY

PROJECT J

Preparation of layout plan for Miyar Industrial Area near Karkala, Udupi District, under contract No. 20.30 ACRES.

CLIENT

KARNATAKA INDUSTRIAL AREAS DEVELOPMENT BOARD

TITLE

LAYOUT MAP OF MIYAR INDUSTRIAL AREA NEAR KARKALA, UDUPI DISTRICT.

CONSULTANTS

GAMA INFRA TECH
 INFRASTRUCTURE CONSULTANTS & ENGINEERS
 # 805, 2nd FLOOR, 13TH MAIN, D BLOCK,
 SHANMUKHAWANAHALLI, KADUR - 576002.
 PHONE: 08240-4188800/4188888000
 E-MAIL: G-gamainfra@rediffmail.com

LAYOUT PLAN SHOWING THE STATUS OF THE PLOT PERTAINING TO NANDIKUR INDUSTRIAL AREA, UDUPI TALUK & DISTRICT

(TOTAL EXTENT 86.64 ACRES)

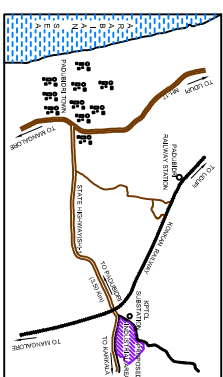

KEY MAP

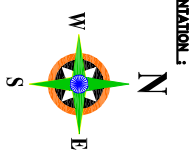

ORIENTATION

LAND USE DETAILS

DESCRIPTIONS	No. of	AREA IN ACRES	%
Industrial	76	47.62	54.96
C.A.	5	4.98	5.75
UTILITY	2	17.14	19.79
Park/Green Zone	2	4.33	5.00
TRANSPARENCY	2	12.57	14.50
ROADS	85	85.64	100.00
TOTAL			

ALLOWABLE

DESCRIPTIONS	AREA IN ACRES	%
SC/ST	10.73	22.53
MSE	9.54	20.03
OTHERS	27.35	57.44
TOTAL	47.62	100.00

ROAD DETAILS

Sl. No	DESCRIPTION	WIDTH IN MTR	LENGTH IN MTRS
1	1st MAIN	12	488.00
2	2nd MAIN	12	239.50
3	3rd MAIN	18	557.00
4	4th MAIN	12	345.00
5	5th MAIN	12	380.00
6	1st CROSS	12	505.00
7	2nd CROSS	24	482.00
8	3rd CROSS	12	523.00
	TOTAL		3499.50

C.A. Plots

- Plot No. A1 : 0.60 Acres
- Plot No. A2 : 0.55 Acres
- Plot No. A3 : 0.62 Acres
- Plot No. A4 : 0.30 Acres
- Plot No. A5 : 0.38 Acres

NO.	DESCRIPTION
U-1	SOLID WASTE DISPOSAL
U-2	GIFT & GLASS OTHER WATER SUPPLY WORKS ETC.
A-1	TELEPHONE EXCHANGE
A-2	FUEL STATION
A-3	KIOSK OFFICE
A-4	BUS STAND
A-5	INDUSTRIES ASSN.

CLIENT:
KARNATAKA INDUSTRIAL AREAS
DEVELOPMENT BOARD (KIADB)

TITLE
LAYOUT MAP OF NANDIKUR
INDUSTRIAL AREA,
UDUPI DISTRICT,
EXTENT OF 86.64

CONSULTANT:

GAMA INFRA
INFRASTRUCTURE CONSULTANTS + ENGINEERS
950, 2nd FLOOR, 13TH MAIN, D BLOCK,
SHARAKHANAGARA BANGALORE-560092,
PHONE NO.080-41888900 / 41888901
E-MAIL: D.gamin@infraengg.com

DRG NO. GAMA/KIADB/DPR-NR-2/R31-0-1

Note : Layout plan approved in the Board meeting dttd. 02-02-2011

KARNATAKA INDUSTRIAL AREAS DEVELOPMENT BOARD**DETAILS OF VACANT CA/AMENITY PLOTS AVAILABLE IN INDUSTRIAL AREAS****MANGALORE ZONE****District: Dakshina Kannada****Name of the Indl. Area: Baikampadi**

Sl.No.	CA/Amenity Plot No.	Extent (in acres)	Reserved for Gen or SC/ST category	Tentative Allotment rate per acre (Rs.in lakhs)
1	Near Plot No.126-A1	0.086	SC/ST	Prevailing guidance value
2	Near Plot No.315-A	0.10	Gen	Prevailing guidance value
	Total	0.186		

Name of the Indl. Area: EPIP 1st Phase

Sl.No.	CA/Amenity Plot No.	Extent (in acres)	Reserved for Gen and SC/ST category	Tentative Allotment rate per acre (Rs.in lakhs)
1	Block No.19	0.50	Gen	50.00
2	Block No.19-P	1.00	SC/ST	50.00
3	Block No.23	2.00	Gen	50.00
4	Block No.25	0.75	Gen	50.00
	Total	4.25		

District: UDUPI**Name of the Indl. Area: Nandikur**

Sl.No.	CA/Amenity Plot No.	Extent (in acres)	Reserved for Gen and SC/ST category	Tentative Allotment rate per acre (Rs.in lakhs)
1	Plot No.A1	0.60	Gen	82.00
2	Plot No.A2	0.55	Gen	82.00
3	Plot No.A3	0.62	SC/ST	82.00
4	Plot No.A4	0.30	Gen	82.00
5	Plot No.A5	0.38	Gen	82.00
	Total	2.45		

Name of the Indl. Area: Belapu				
Sl.No.	CA/Amenity Plot No.	Extent (in acres)	Reserved for Gen and SC/ST category	Tentative Allotment rate per acre (Rs.in lakhs)
1	Plot No.A1	1.00	Gen	66.00
2	Plot No.A2	0.50	SC/ST	66.00
3	Plot No.A3	0.50	Gen	66.00
	Total	2.00		
Name of the Indl. Area: Miyar				
Sl.No.	CA/Amenity Plot No.	Extent (in acres)	Reserved for Gen and SC/ST category	Tentative Allotment rate per acre (Rs.in lakhs)
1	Plot No.A1	0.27	Gen	48.00
2	Plot No.A2	0.17	SC/ST	48.00
	Total	0.44		