

D	1.0m X 2.1m
D1	0.75m X 2.1m
W	1.5m X 1.2m
W1	1.2m X 1.2m
V	0.75m X 0.6m

ROAD

MIG

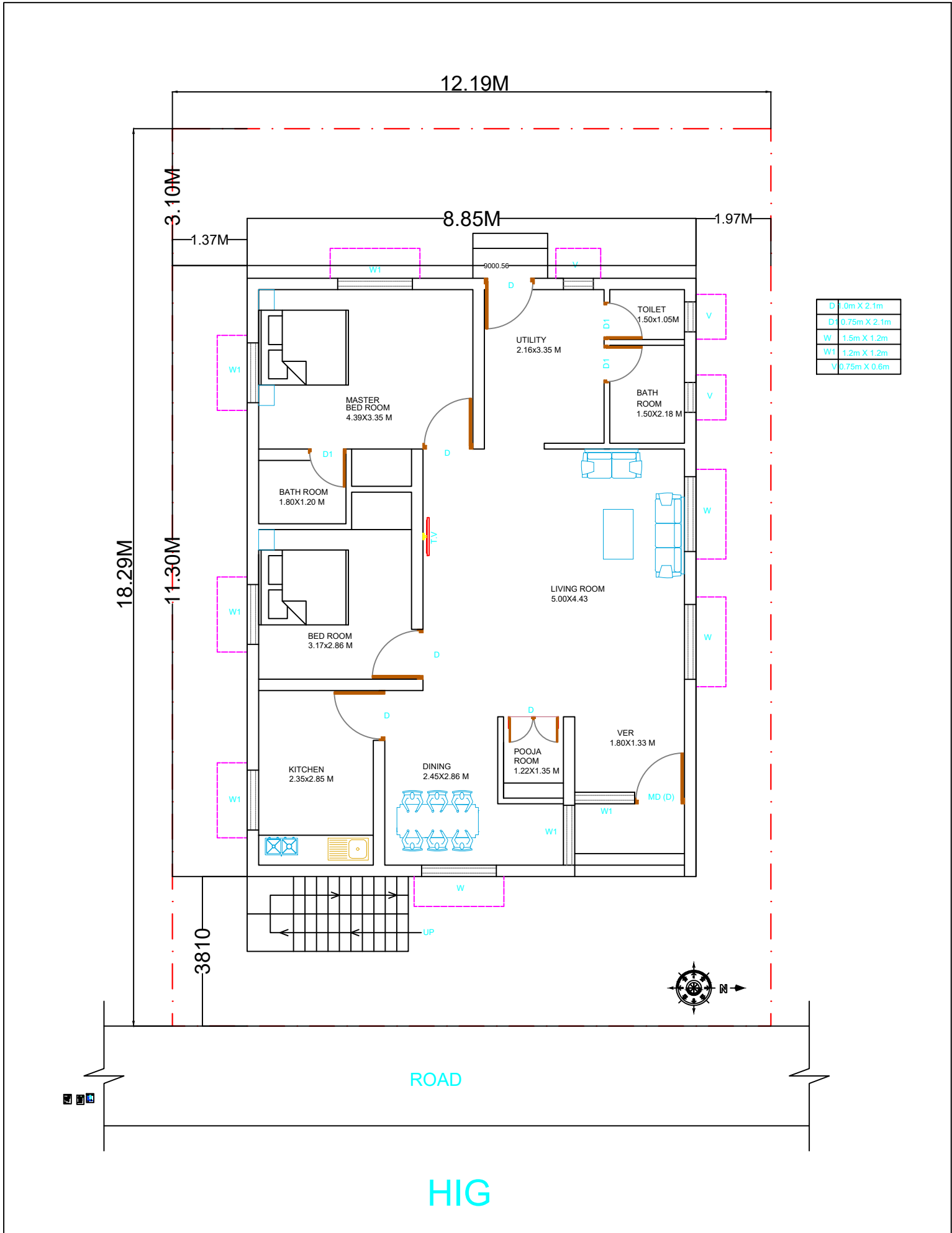

KARNATAKA INDUSTRIAL AREAS DEVELOPMENT BOARD			
RESIDENTIAL LAYOUT			
VASANTHNARASAPURA INDUSTRIAL AREA 3rd PHASE, TUMKURU			
INDIVIDUAL HOUSES BUILT ON INDIVIDUAL SITES			
L I G HOUSES			
DETAILS OF L I G RESIDENTAL HOUSES AVAILABLE FOR ALLOTMENT THROUGH E-Auction.			
Sl No	Plot No./Site No,	Plot /Site Size (in m)	Built Up area (in Sqmt)
1	345	9.14x12.19	52.20
2	346	9.14x12.19	52.20
3	347	9.14x12.19	52.20
4	348	9.14x12.19	52.20
5	349	9.14x12.19	52.20
6	350	9.14x12.19	52.20
7	351	9.14x12.19	52.20
8	352	9.14x12.19	52.20
9	353	9.14x12.19	52.20
10	354	9.14x12.19	52.20
11	355	9.14x12.19	52.20
12	356	9.14x12.19	52.20
13	357	9.14x12.19	52.20
14	358	9.14x12.19	52.20
15	359	9.14x12.19	52.20
16	360	9.14x12.19	52.20
17	382	9.14x12.19	52.20
18	383	9.14x12.19	52.20
19	384	9.14x12.19	52.20
20	385	9.14x12.19	52.20
21	386	9.14x12.19	52.20
22	387	9.14x12.19	52.20
23	388	9.14x12.19	52.20
24	389	9.14x12.19	52.20
25	390	9.14x12.19	52.20

Sl No	Plot No./Site No,	Plot /Site Size (in m)	Built Up area (in Sqmt)
26	391	9.14x12.19	52.20
27	392	9.14x12.19	52.20
28	393	9.14x12.19	52.20
29	394	9.14x12.19	52.20
30	395	9.14x12.19	52.20
31	396	9.14x12.19	52.20
32	397	9.14x12.19	52.20
33	398	9.14x12.19	52.20
34	420	9.14x12.19	52.20
35	421	9.14x12.19	52.20
36	422	9.14x12.19	52.20
37	423	9.14x12.19	52.20
38	424	9.14x12.19	52.20
39	425	9.14x12.19	52.20
40	426	9.14x12.19	52.20
41	427	9.14x12.19	52.20
42	428	9.14x12.19	52.20
43	429	9.14x12.19	52.20
44	430	9.14x12.19	52.20
45	431	9.14x12.19	52.20
46	432	9.14x12.19	52.20
47	433	9.14x12.19	52.20
48	434	9.14x12.19	52.20
49	435	9.14x12.19	52.20
50	436	9.14x12.19	52.20

Karnataka Industrial Area Development Board				
Residential Layout of Vasanthanarsapura Industrial Area, 3rd Phase, Tumakuru District				
Details of Residential Houses for E-Auction - MIG				
Sl No	Type Of Housing Tenement	Plot No	Plot Size (m)	Built Up area Sqmt
1	MIG	458	9.14x15.24	78.95
2	MIG	459	9.14x15.24	78.95
3	MIG	460	9.14x15.24	78.95
4	MIG	461	9.14x15.24	78.95
5	MIG	462	9.14x15.24	78.95
6	MIG	463	9.14x15.24	78.95
7	MIG	464	9.14x15.24	78.95
8	MIG	465	9.14x15.24	78.95
9	MIG	466	9.14x15.24	78.95
10	MIG	467	9.14x15.24	78.95
11	MIG	468	9.14x15.24	78.95
12	MIG	469	9.14x15.24	78.95
13	MIG	470	9.14x15.24	78.95
14	MIG	471	9.14x15.24	78.95
15	MIG	472	9.14x15.24	78.95
16	MIG	473	9.14x15.24	78.95
17	MIG	474	9.14x15.24	78.95
18	MIG	509	9.14x15.24	78.95
19	MIG	510	9.14x15.24	78.95
20	MIG	511	9.14x15.24	78.95

Karnataka Industrial Area Development Board				
Residential Layout of Vasanthanarsapura Industrial Area, 3rd Phase, Tumakuru District				
Details of Residential Houses for E-Auction - HIG				
Sl No	Type Of Housing Tenement	Plot No	Plot Size (m)	Built Up area Sqmt
1	HIG	533	12.19x18.29	99.86
2	HIG	534	12.19x18.29	99.86
3	HIG	535	12.19x18.29	99.86
4	HIG	536	12.19x18.29	99.86
5	HIG	537	12.19x18.29	99.86
6	HIG	539	12.19x18.29	99.86
7	HIG	540	12.19x18.29	99.86
8	HIG	541	12.19x18.29	99.86
9	HIG	542	12.19x18.29	99.86
10	HIG	543	12.19x18.29	99.86
11	HIG	544	12.19x18.29	99.86
12	HIG	549	12.19x18.29	99.86
13	HIG	550	12.19x18.29	99.86
14	HIG	551	12.19x18.29	99.86
15	HIG	552	12.19x18.29	99.86
16	HIG	553	12.19x18.29	99.86
17	HIG	554	12.19x18.29	99.86
18	HIG	555	12.19x18.29	99.86
19	HIG	556	12.19x18.29	99.86
20	HIG	557	12.19x18.29	99.86
21	HIG	558	12.19x18.29	99.86
22	HIG	559	12.19x18.29	99.86
23	HIG	560	12.19x18.29	99.86
24	HIG	561	12.19x18.29	99.86
25	HIG	563	12.19x18.29	99.86
26	HIG	564	12.19x18.29	99.86
27	HIG	565	12.19x18.29	99.86
28	HIG	566	12.19x18.29	99.86
29	HIG	572	12.19x18.29	99.86
30	HIG	573	12.19x18.29	99.86
31	HIG	580	12.19x18.29	99.86
32	HIG	581	12.19x18.29	99.86
33	HIG	586	12.19x18.29	99.86
34	HIG	587	12.19x18.29	99.86
35	HIG	588	12.19x18.29	99.86
36	HIG	589	12.19x18.29	99.86
37	HIG	595	12.19x18.29	99.86
38	HIG	596	12.19x18.29	99.86