

KARNATAKA INDUSTRIAL AREAS DEVELOPMENT BOARD				
DETAILS OF CA/AMENITY PLOTS PROPOSED FOR ALLOTMENT				
ABSTRACT OF CA/AMENITY PLOTS				
DHARAWAD ZONE				
District: Dharawad		Name of the Indl. Area: Kotur Belur		
Sl.No.	CA/Amenity Plot No.	Extent (in acres)	Reserved for Gen and SC/ST category	Tentative Allotment rate per acre (Rs.in lakhs)
1	22	1.15	Gen	86.00
2	99	1.50	Gen	86.00
3	99-P	0.84	SC/ST	86.00
	Total	3.49		
District: Dharawad		Name of the Indl. Area: Gamanagatti 1st Stage		
Sl.No.	CA/Amenity Plot No.	Extent (in acres)	Reserved for Gen and SC/ST category	Tentative Allotment rate per acre (Rs.in lakhs)
1	2	2.21	SC/ST	98.00
2	5-B & 5-C	4.00	Gen	98.00
	Total	6.21		
District: Dharawad		Name of the Indl. Area: Rayapura		
Sl.No.	CA/Amenity Plot No.	Extent (in acres)	Reserved for Gen and SC/ST category	Tentative Allotment rate per acre (Rs.in lakhs)
1	92	3.41	Gen	Prevailing guidance value
2	93-P1	1.05	SC/ST	Prevailing guidance value
	Total	4.46		
District: Dharawad		Name of the Indl. Area: Mummigatti		
Sl.No.	CA/Amenity Plot No.	Extent (in acres)	Reserved for Gen and SC/ST category	Tentative Allotment rate per acre (Rs.in lakhs)
1	171	4.56	Gen	139.00
2	171-P1	1.44	SC/ST	139.00
	Total	6.00		
District: Gadag		Name of the Indl. Area: Narasapura		
Sl.No.	CA/Amenity Plot No.	Extent (in acres)	Reserved for Gen and SC/ST category	Tentative Allotment rate per acre (Rs.in lakhs)
1	54-P	0.74	SC/ST	75.00
2	144	2.00	Gen	75.00
	Total	2.74		

Sketch Showing the details of CA Land Plot No 22 in Kotur-Belur Industrial Area , Dharwad District .

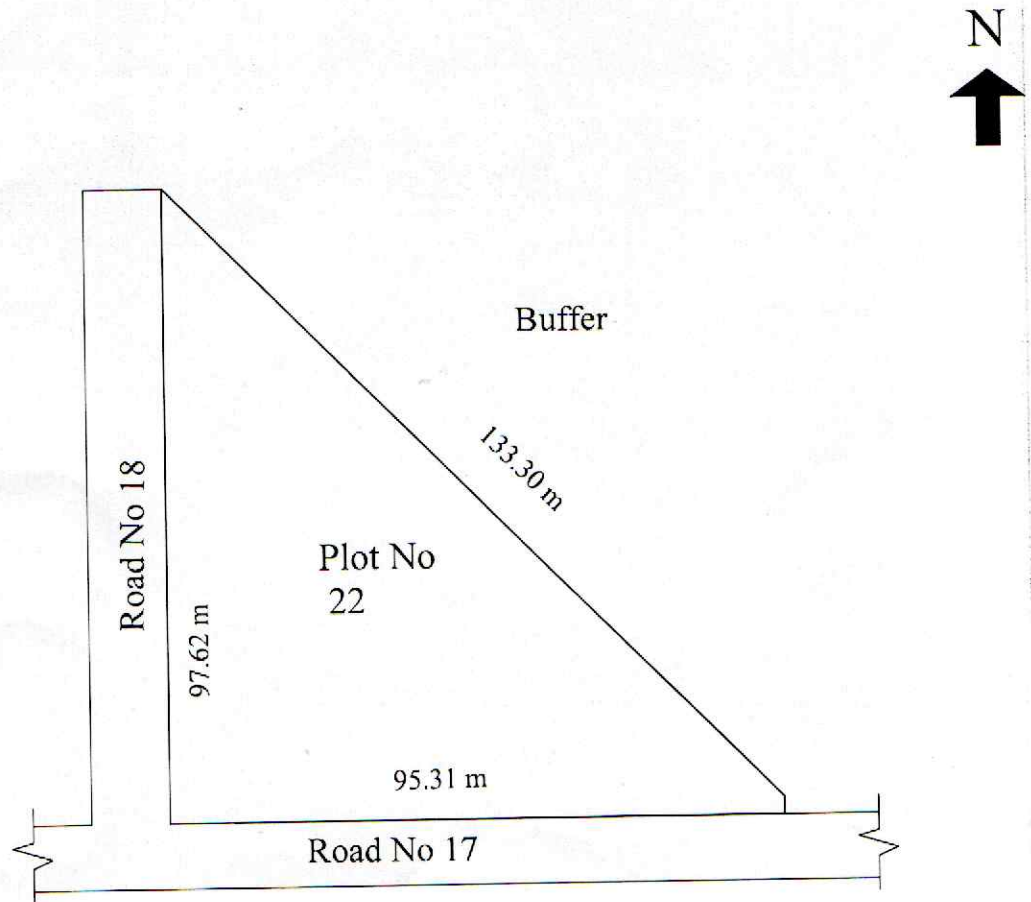

$$\text{Total Extent : } \frac{(95.31 \times 97.62)}{2} = 4652.08 \text{ Sqm}$$

or 1.15 Acre

[Signature]
Assistant Engineer
KIADB Dharwad

[Signature]
Asst Executive Engineer
KIADB Dharwad

[Signature]
Executive Engineer
KIADB Dharwad

Sketch Showing the details of CA Land Plot No 99 in
Kotur -Belur Industrial Area , Dharwad District.

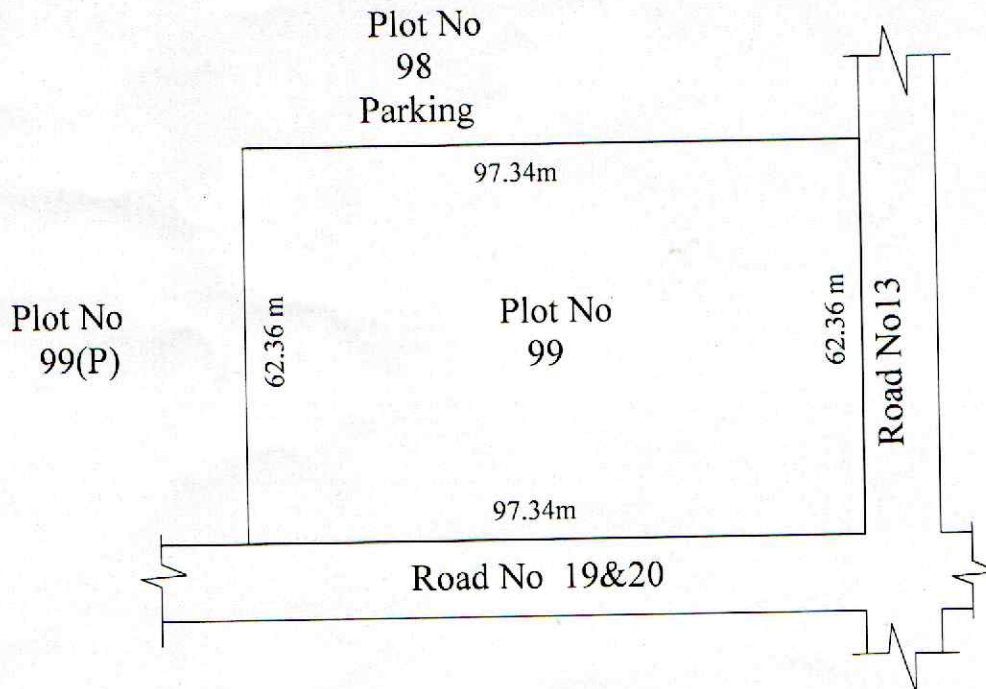

Total Extent : $97.34 \times 62.36 = 6070.122 \text{ Sqm}$
or 1.50 Acre

Assistant Engineer
KIADB Dharwad



Asst Executive Engineer
KIADB Dharwad

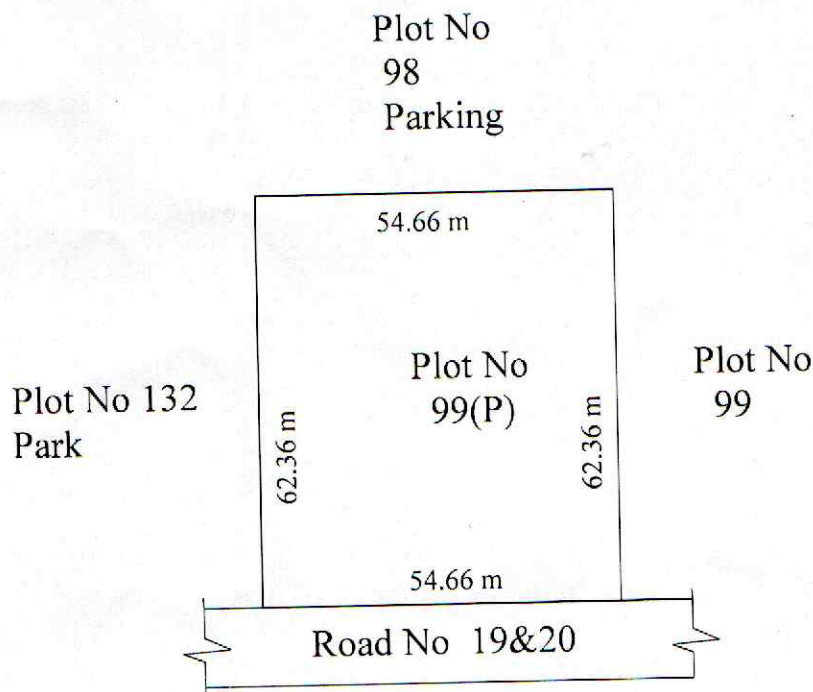

Executive Engineer
KIADB Dharwad

Sketch Showing the details of CA Land Plot No 99(P)
in Kotur Belur Industrial Area , Dharwad District.



Total Extent : $54.66 \times 62.36 = 3408.59 \text{ Sqm}$
or 0.84 Acre

Assistant Engineer
KIADB Dharwad

Asst Executive Engineer
KIADB Dharwad

Executive Engineer
KIADB Dharwad

Sketch Showing the details of CA Land Plot No 2 in Gamanagatti Industrial Area , Dharwad District

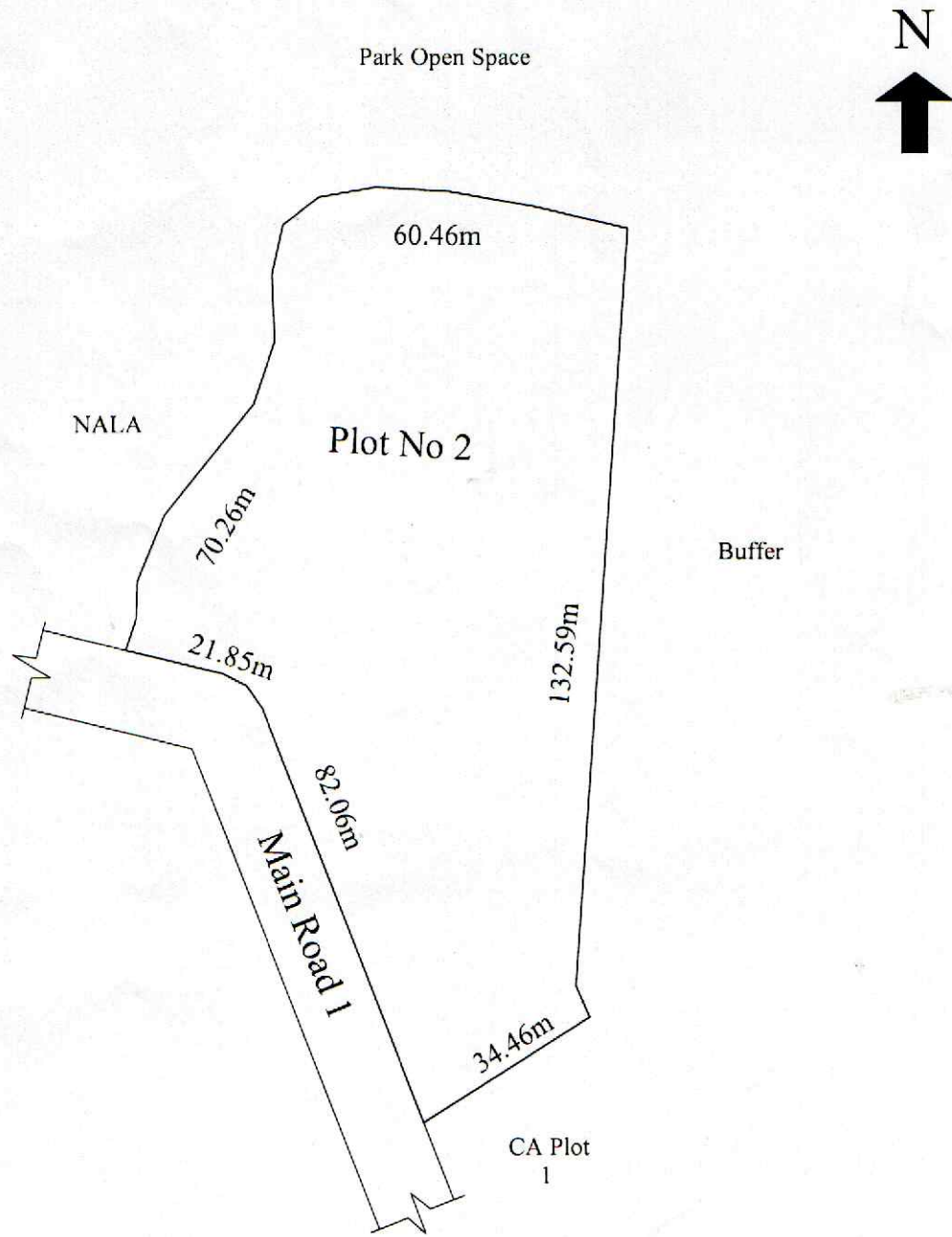

Extent : 2.21 Acre

[Signature]

Assistant Engineer
KIADB Dharwad

[Signature]

Asst Executive Engineer
KIADB Dharwad

[Signature]

Executive Engineer
KIADB Dharwad

Sketch Showing the details of CA Land Plot No 5/b and 5/c in Gamanagatti Industrial Area , Dharwad District

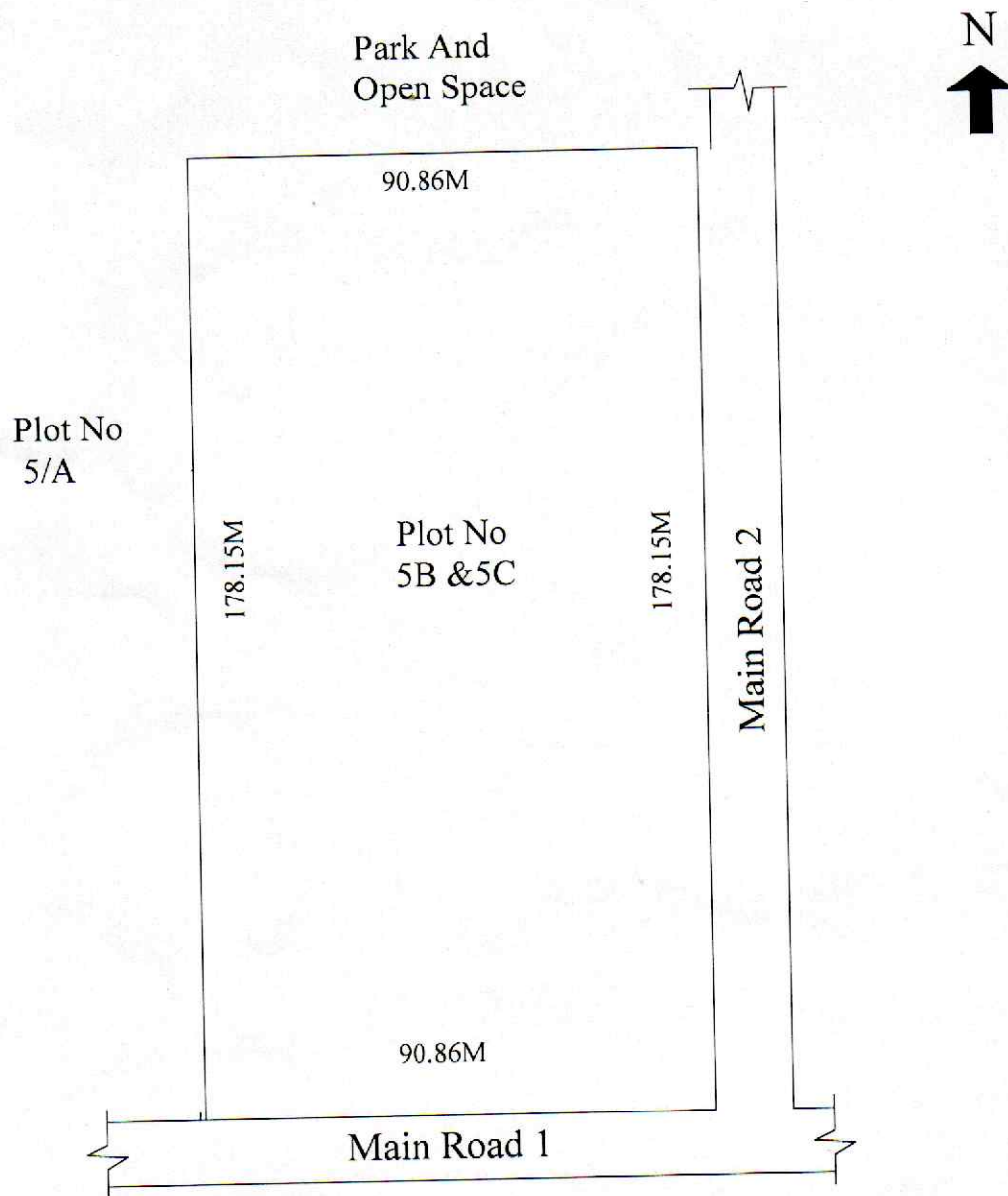

Extent: $90.86 \times 178.15 = 16186.70$ Sqm
or 4.00 Acre

Assistant Engineer
KIADB Dharwad

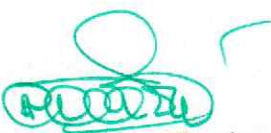
Asst Executive Engineer
KIADB Dharwad

Executive Engineer
KIADB Dharwad

Sketch Showing the details of CA Land Plot No 92 in Rayapur Industrial Area, Dharwad District.

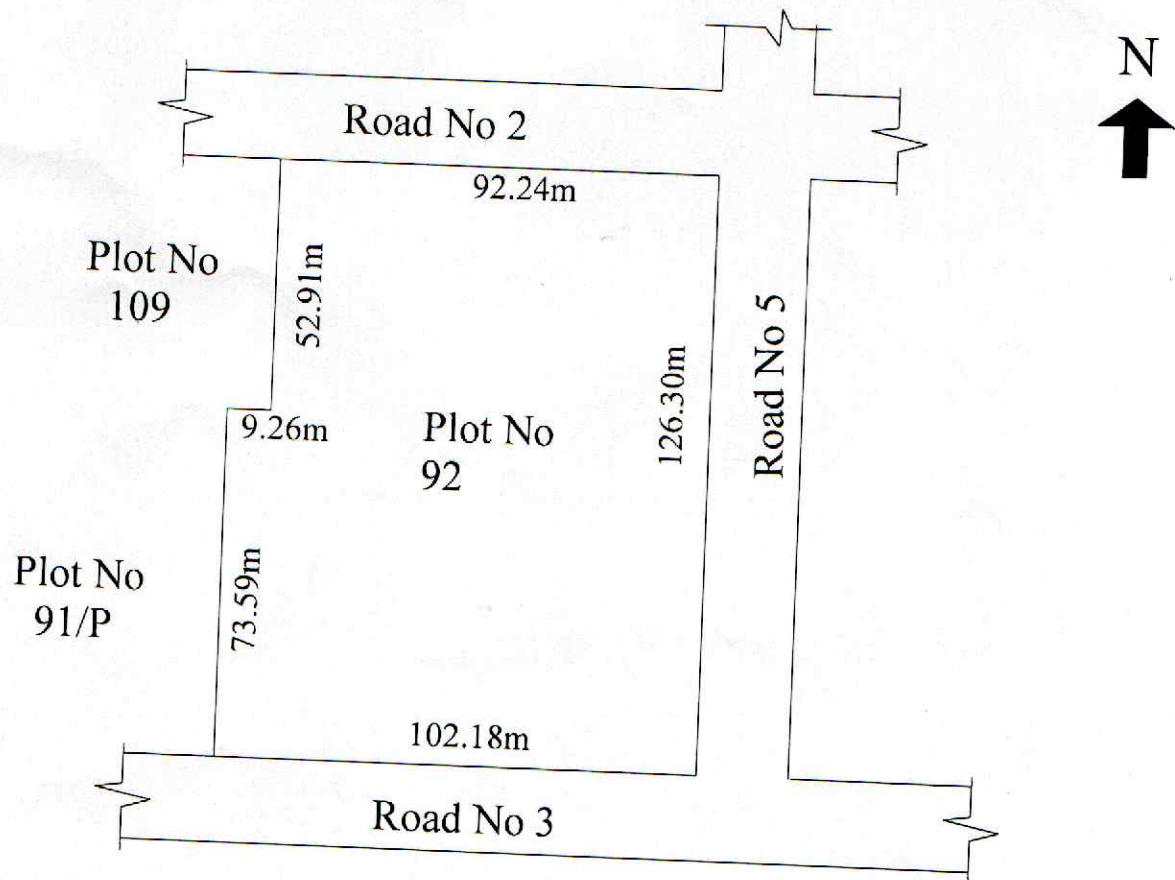

Extent : 3.41 Acre

[Signature]
Assistant Engineer
KIADB Dharwad

[Signature]
Asst Executive Engineer
KIADB Dharwad

[Signature]
Executive Engineer
KIADB Dharwad

Sketch Showing the details of CA Land Plot No 93(P1) in
Rayapur Industrial Area, Dharwad District

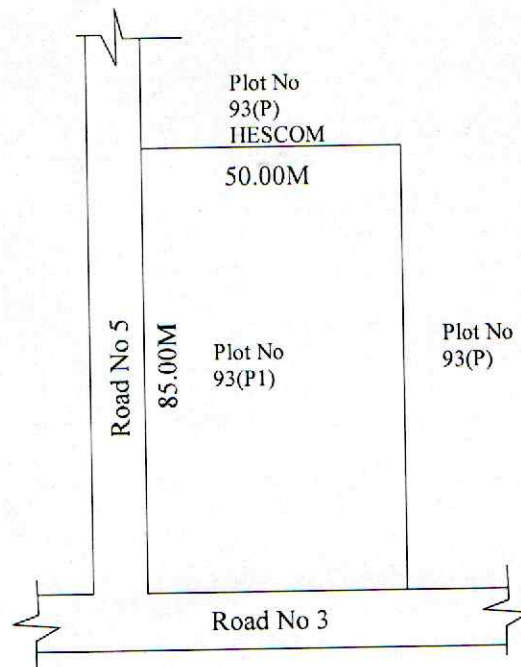

Total Extent : $50.00 \times 85.00 = 4250.00$ Sqm
or 1.05 Acre

Assistant Engineer
KIADB Dharwad

Asst Executive Engineer
KIADB Dharwad

Executive Engineer
KIADB Dharwad

Sketch Showing the details of CA Land Plot No 54/P in Narasapur Industrial Area, Gadag District.

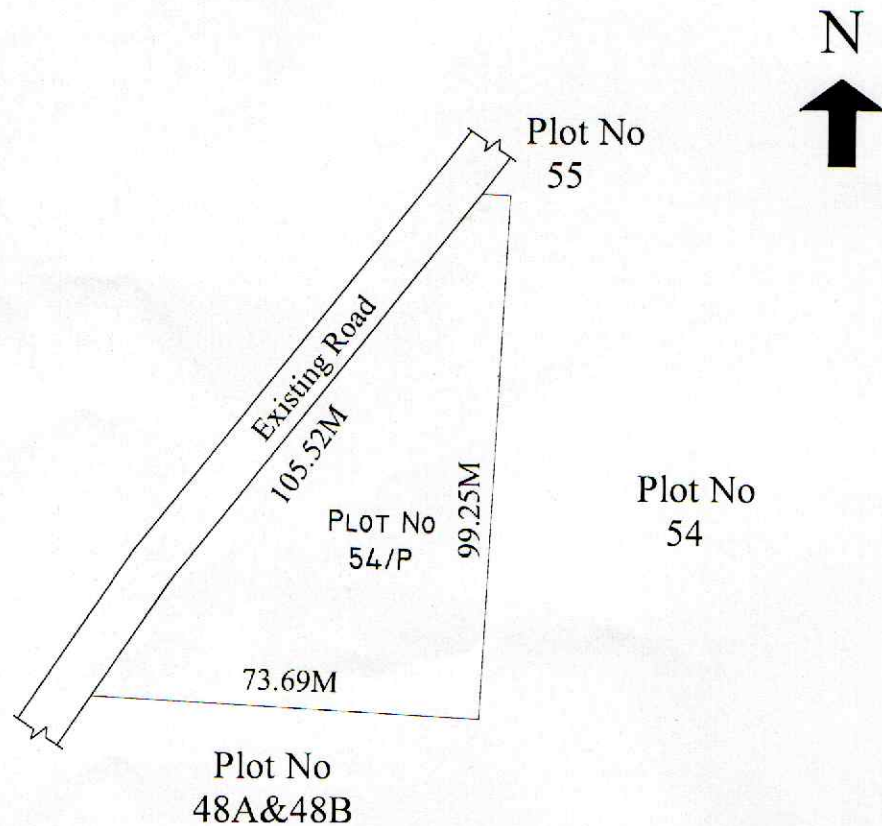

Extent : 0.74 Acre

[Signature]
Assistant Engineer
KIADB Dharwad

[Signature]
Asst Executive Engineer
KIADB Dharwad

[Signature]
Executive Engineer
KIADB Dharwad

Sketch Showing the details of CA Land Plot No 144 in
Narasapur Industrial Area , Gadag District

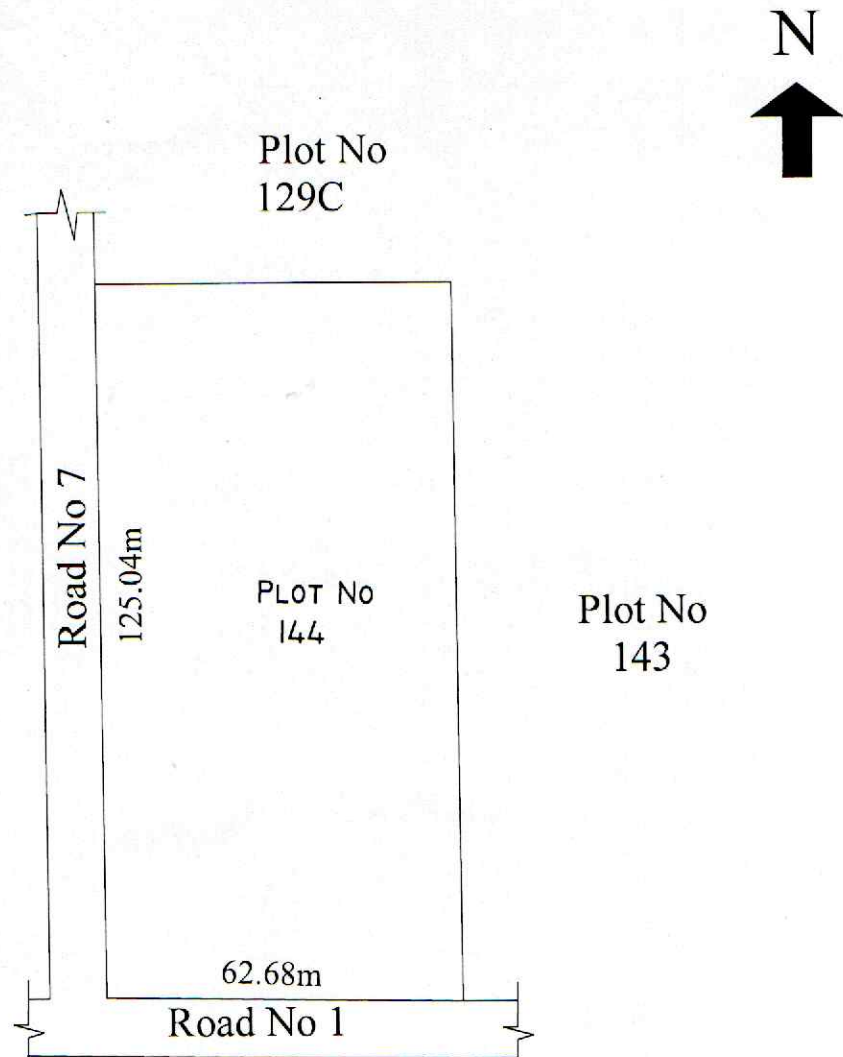

Total Extent : $62.68 \times 125.04 = 7837.50$ Sqm
or 2.00Acre

Assistant Engineer
KIADB Dharwad

Asst Executive Engineer
KIADB Dharwad

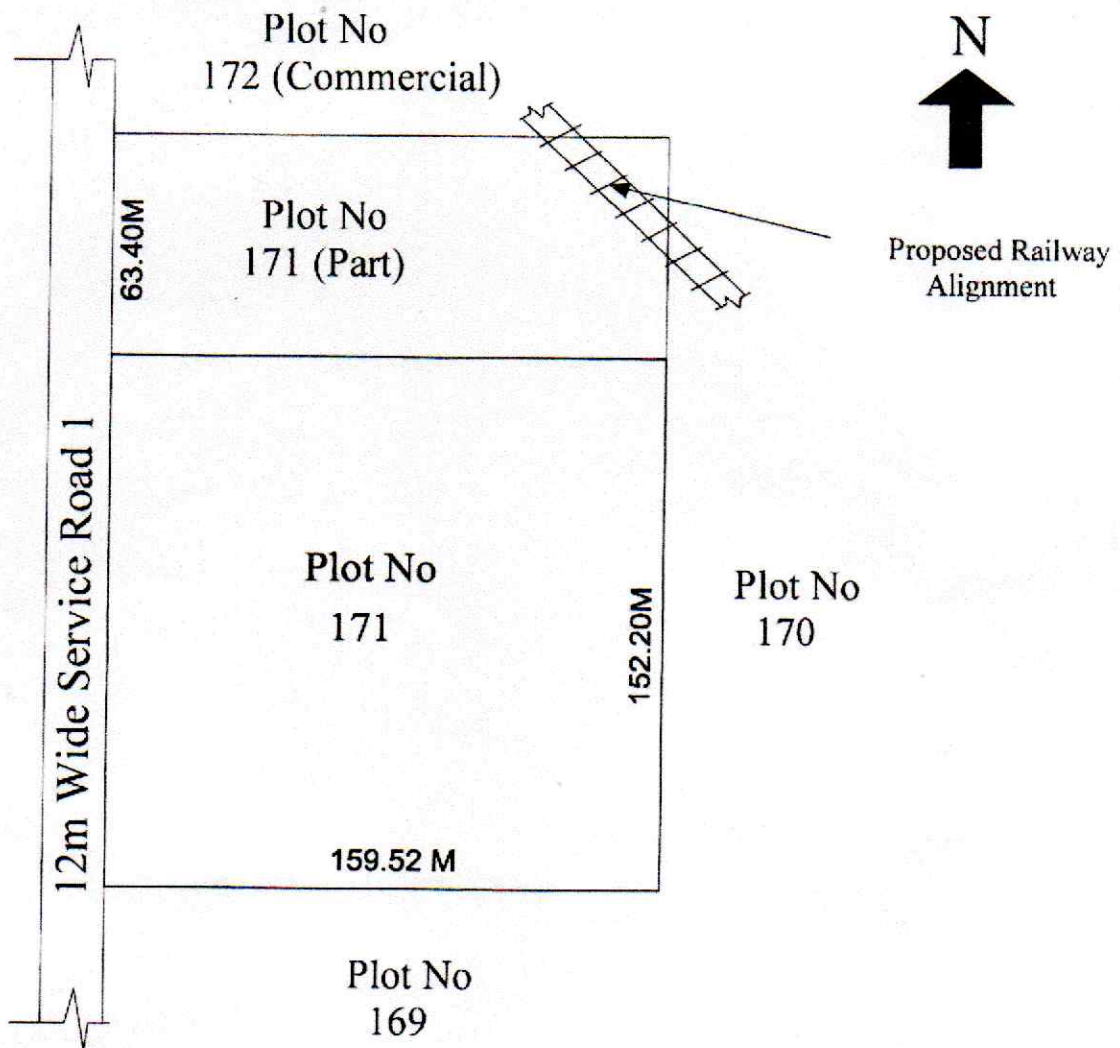

Executive Engineer
KIADB Dharwad

Sketch Showing the details of CA Land Plot No 171 in Mummigatti Industrial Area , Dharwad District

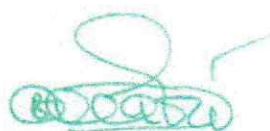

Extent : Plot No-171 :6.00Acre
Plot No-171(P) :2.50Acre (Proposed Railway Alignment)

Assistant Engineer
KIADB Dharwad

Asst Executive Engineer
KIADB Dharwad

Executive Engineer
KIADB Dharwad